

CITY OF PRESCOTT

PRESCOTT REGIONAL AIRPORT ERNEST A. LOVE FIELD

PRESCOTT, ARIZONA

AS BUILT DATE

DIBBLE

MAYOR
PHIL GOODE

CITY COUNCIL
CONNIE CANTELME (MAYOR PRO TEM)
BRANDON MONTOYA
ERIC MOORE
CATHEY RUSING
LOIS FRUHWIRTH
TED GAMBOGI

CITY MANAGER
TYLER GOODMAN (INTERIM)

AIRPORT MANAGEMENT
KELLY FREDERICKS (INTERIM AIRPORT DIRECTOR)
PETE TOWNSEND (AIRPORT OPERATIONS)
JOHN KUEBRICH (CAPITAL PROJECTS MANAGER)

SAFE - OFF-SITE DRAINAGE IMPROVEMENTS

ADOT PROJECT NO. E3S3C01D
PRC PROJECT NO. 2024-066-11

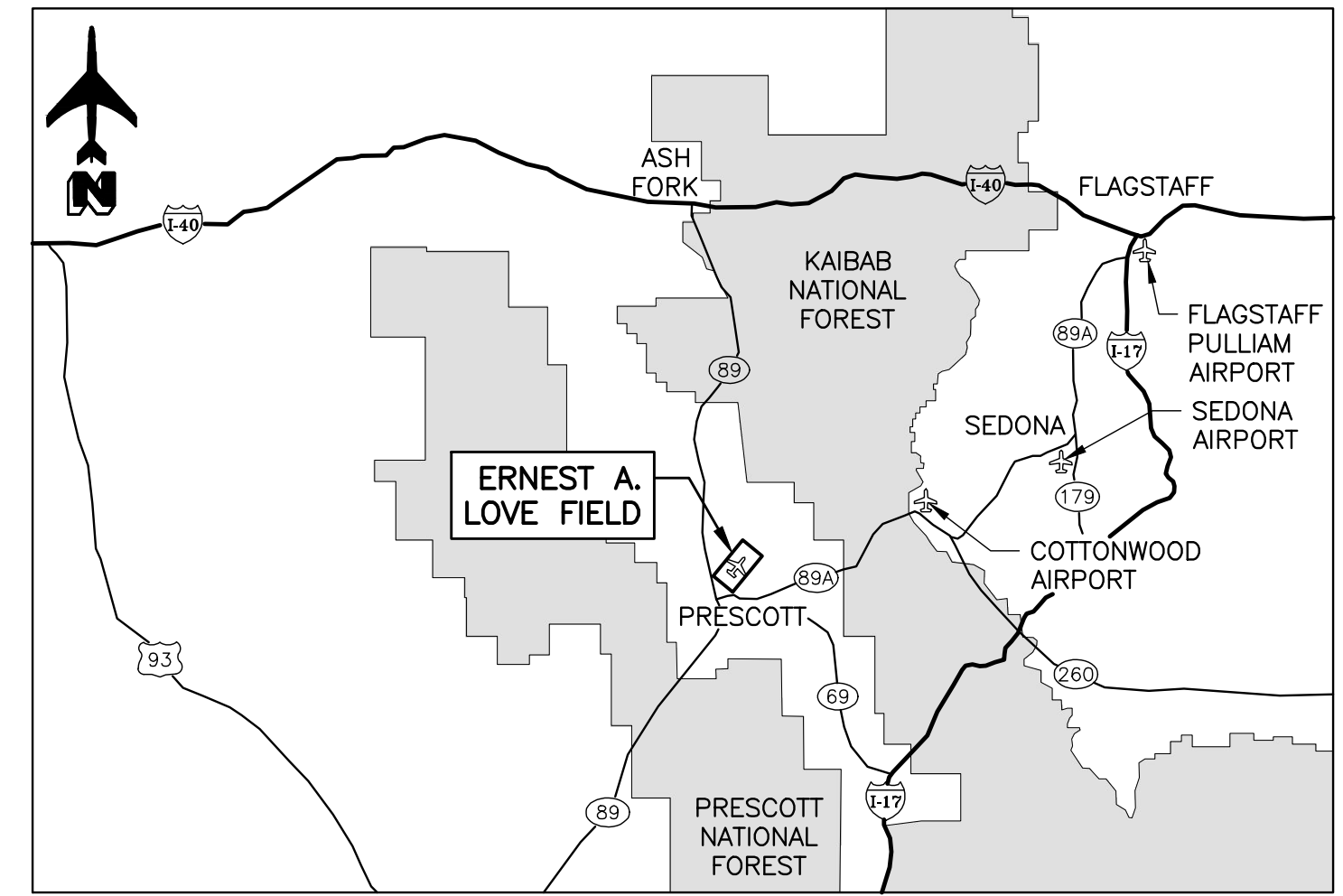

VICINITY MAP
NTS

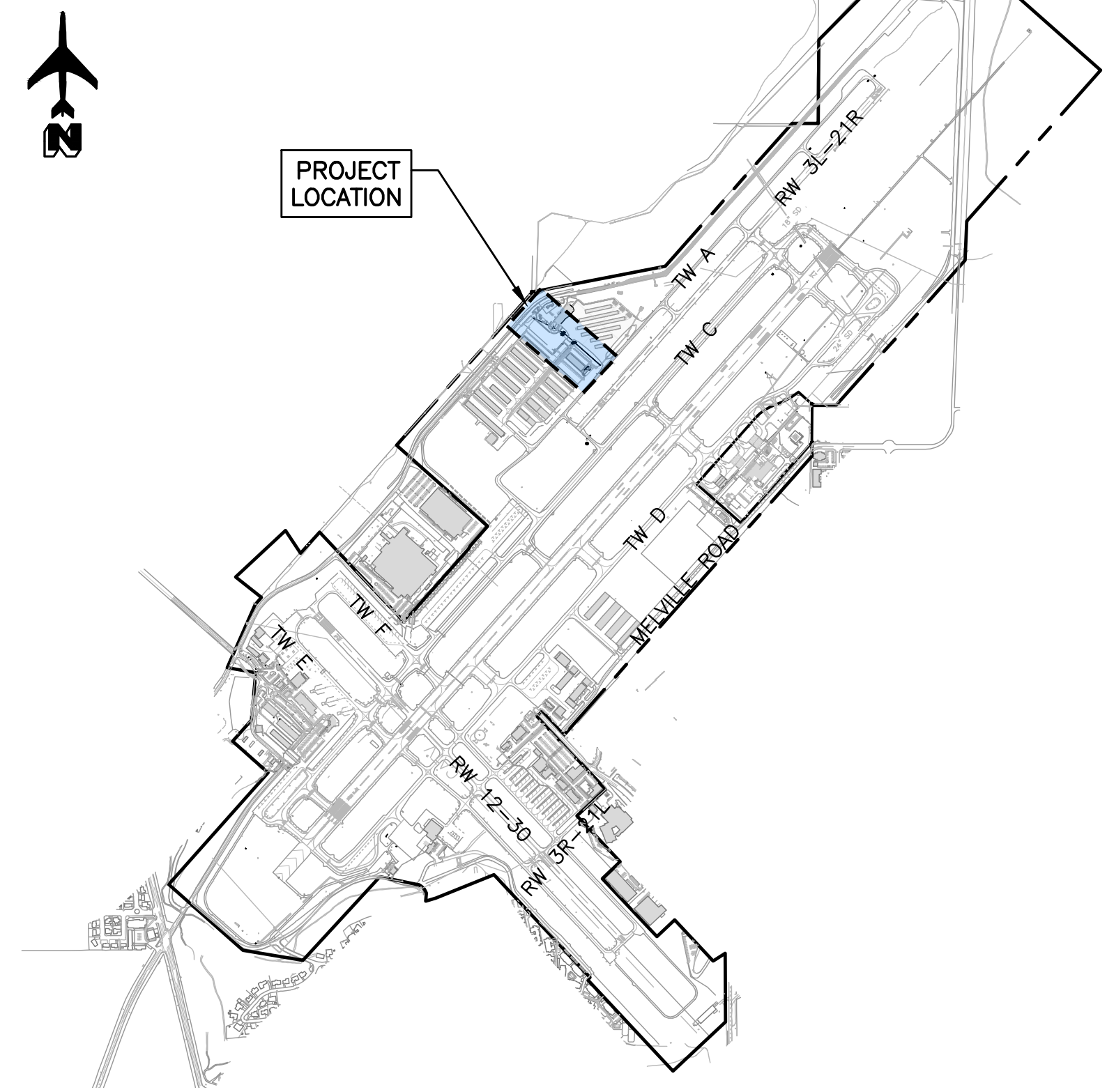

LOCATION MAP
T15N R2W, SEC24 NTS

COORDINATION LIST

ORGANIZATION	CONTACT	PHONE
DESIGN		
ENGINEER (CIVIL)	DUANE DANA	480-757-7876
SURVEYOR	JASON GRAHAM	602-957-1155

RECORD DRAWING CERTIFICATION

I HEREBY CERTIFY, TO THE BEST OF MY KNOWLEDGE, INFORMATION AND BELIEF, THAT THIS PROJECT HAS BEEN COMPLETED IN SUBSTANTIAL CONFORMANCE WITH THE APPROVED PLANS, SPECIFICATIONS AND REFERENCED STANDARDS, EXCEPT AS SHOWN HEREON; THAT THESE RECORD DRAWING PLANS REFLECT THE POSITION OF CONSTRUCTED IMPROVEMENTS BASED ON FIELD MEASUREMENTS; AND THAT THE MATERIALS USED IN CONSTRUCTION ARE AS SHOWN BASED ON FIELD OBSERVATION AND TEST RESULTS.

THIS CERTIFICATION DOES NOT WARRANT MATERIALS, WORKMANSHIP, METHODS OF CONSTRUCTION, OR OTHER ITEMS AFFECTING THE WARRANTY OF THIS PROJECT, TO THE CITY OF PRESCOTT. USERS OF THIS INFORMATION ARE ADVISED TO OBTAIN INDEPENDENT VERIFICATION OF ACTUAL CONDITIONS.

REGISTERED CIVIL ENGINEER _____ DATE _____
REGISTRATION NUMBER _____

CONSTRUCTION INSPECTION APPROVAL

CONTRACTOR _____ DATE _____
PERMIT NUMBER _____ DATE _____
APPROVED: _____ DATE _____
CITY OF PRESCOTT INSPECTOR

APPROVALS

APPROVED: _____ DATE _____
CITY ENGINEER
APPROVED: _____ DATE _____
UTILITIES MANAGER
APPROVED: _____ DATE _____
PROGRAM DEVELOPMENT MANAGER

ORGANIZATION	FACILITY	CONTACT	PHONE	DATE SENT	RESPONSE
UTILITIES					
ARIZONA PUBLIC SERVICE	POWER	BECKY RUDD-LACY	928-443-6657	11/13/2023	12/06/2023
CABLE ONE	CATV	BILL VAN GAASBEEK	928-713-2918	11/13/2023	12/06/2023
CITY OF PRESCOTT	UTILITIES	JOHN KUEBRICH	928-777-1114 X4665	11/13/2023	12/05/2023
CENTURYLINK/LUMEN	TELEPHONE (DESIGN REVIEW)	ARMEN MCNERLIN	928-777-1114 X4665	11/13/2023	11/20/2023
UNISOURCE ENERGY SERVICES	GAS	MALI ROSS	928-237-6818	11/13/2023	12/11/2023

REVISION	BY	DATE

CITY OF PRESCOTT
PRESCOTT REGIONAL AIRPORT
PRC PROJECT NO 2024-066-11 | DIBBLE PROJECT NO 1023143.11
SAFE - OFF-SITE DRAINAGE IMPROVEMENTS

COVER SHEET

DRN: DSO	DES: MJH	CK: DHD	DRAWING	SHEET
DATE: 04/2024	DATE: 04/2024	DATE: 04/2024	CG1.0	1 OF 14



J:\2023\1023143.11_PRC_SAFE_DRAINAGE_IMPROVEMENTS\CAD\1023143.11-CG1.X - COVR.DWG Apr. 11, 2024 3:02 PM

PRC SAFE - OFF-SITE DRAINAGE IMPROVEMENTS, 100% SUBMITTAL, 4/11/2024

ABBREVIATIONS	
ABC	AGGREGATE BASE COURSE
AC	ASPHALT CONCRETE
ARV	AIR-RELEASE VALVE
ASOS	AUTOMATED SURFACE OBSERVING SYSTEM
BCF	BRASS CAP FLUSH
BM	BENCHMARK
CL	CENTERLINE
CONT ITEM	CONTINGENT ITEM
CONST	CONSTRUCTION
COP	CITY OF PRESCOTT
CP	CONTROL POINT
CMP	CORRUGATED METAL PIPE
CVID	CHINO VALLEY IRRIGATION DISTRICT
DIP	DUCTILE IRON PIPE
EOP	EDGE OF PAVEMENT
EX, EXST	EXISTING
FAA	FEDERAL AVIATION ADMINISTRATION
FG	FINISHED GRADE
FL	FLOWLINE
G	GROUND
GR	GRATE
IE, INV	INVERT ELEVATION
LCA	LOCALIZER CRITICAL AREA
LTSG	LIME-TREATED SUBGRADE
MAG	MARICOPA ASSOCIATION OF GOVERNMENTS
ME	MATCH EXISTING
MOD	MODIFIED
NPI	NON-PAY ITEM
OC	ON CENTER
OFA	OBJECT FREE AREA
OFZ	OBJECT FREE ZONE
PCCP	PORTLAND CEMENT CONCRETE PAVEMENT
PC	POINT OF CURVATURE
PRC	POINT OF REVERSE CURVATURE
PT	POINT OF TANGENCY
PUE	PUBLIC UTILITY EASEMENT
PVC	POLYVINYL CHLORIDE
PVMT	PAVEMENT
RCP	REINFORCED CONCRETE PIPE
RGRCP	RUBBER GASKETED REINFORCED CONCRETE PIPE
ROFA	RUNWAY OBJECT FREE AREA
RSA	RUNWAY SAFETY AREA
RW	RUNWAY
STD DET	STANDARD DETAIL
SD	STORM DRAIN
SRHDPE	SPIRAL RIBBED HIGH DENSITY POLYETHYLENE
SS	SANITARY SEWER
SRMP	SPIRAL RIB METAL PIPE
SWPPP	STORM WATER POLLUTION PREVENTION PLAN
TBM	TEMPORARY BENCHMARK
TOFA	TAXIWAY OBJECT FREE AREA
TS&V	TAPPING SLEEVE & VALVE
TSA	TAXIWAY SAFETY AREA
TW	TAXIWAY
TYP	TYPICAL
UNO	UNLESS NOTED OTHERWISE
USFS	U.S. FOREST SERVICE
YAG	YAVAPAI ASSOCIATION OF GOVERNMENTS

LEGEND	
	PROJECT BENCHMARK
	EXISTING CATCH BASIN
	EXISTING PULL BOX/VAULT
	FLOW ARROW
	SOIL BORING LOCATION
	CENTER LINE
	PROPOSED CONTOURS
	GRADE BREAK
	EXISTING CONTOURS
	EXISTING BARBED WIRE FENCE
	EXISTING CHAIN LINK FENCE
	REMOVE/SALVAGE CHAIN LINK FENCE
	GRADING LIMIT LINE
	AIRPORT PROPERTY BOUNDARY
	SAW CUT
	EXISTING WATER SERVICE
	NEW STORM DRAIN FLANGE ASSEMBLY
	EXISTING SANITARY SEWER MANHOLE
	NEW STORM DRAIN PIPE
	NEW RETROREFLECTIVE EDGE MARKER
	NEW ELECTRICAL
	EXISTING ELECTRICAL
	NEW ELEVATED TAXIWAY EDGE LIGHT
	NEW RUNWAY EDGE LIGHT
	EXISTING ELEVATED TAXIWAY EDGE LIGHT
	NEW HANDHOLE
	NEW RUNWAY GUARD LIGHT
	EXISTING RUNWAY GUARD LIGHT
	NEW JUNCTION CAN
	EXISTING AIRFIELD GUIDANCE SIGN
	EXISTING HANDHOLE
	EXISTING RETROREFLECTIVE MARKER
	NEW RETROREFLECTIVE MARKER
	NEW RUNWAY END IDENTIFIER LIGHT
	NEW L-861E LIGHT & BASE
	EXISTING AIRFIELD LIGHT
	NEW AIRFIELD GUIDANCE SIGN
	EXISTING JUNCTION CAN

SHEET INDEX		
SHEET NO	DWG NO	SHEET TITLE
GENERAL		
1	CG1.0	COVER SHEET
2	CG1.1	ABBREVIATIONS, LEGEND, SHEET INDEX & QUANTITIES
3	CG1.2	GENERAL NOTES
4	CG1.3	SURVEY CONTROL PLAN
5	CG1.4	AIRPORT & PROJECT SITE PLAN
CONSTRUCTION PHASING PLAN		
6	CG2.1	OVERALL
7	CG2.2	PHASE 1
GRADING & DRAINAGE		
8	GD1.0	OVERALL PLAN
9	GD1.1	STORM DRAIN PLAN & PROFILE 1
10	GD1.2	STORM DRAIN PLAN & PROFILE 2
11	GD2.1	STORM DRAIN DETAILS
12	GD2.2	RIPRAP DIMENSIONS
STORM WATER POLLUTION PREVENTION PLAN (SWPPP)		
13	SW1.0	SWPPP & EROSION CONTROL PLANS
14	SW1.1	SWPPP & EROSION CONTROL DETAILS

AS BUILT DATE

PRESCOTT REGIONAL AIRPORT SAFE COMPLEX - OFF-SITE DRAINAGE IMPROVEMENTS SCHEDULE II - ADOT FUNDED PROJECT 100% ESTIMATED QUANTITIES					
LINE No.	ITEM No.	DESCRIPTION	APPROX. QTY.	UNIT	AS-BUILT QTY.
CIVIL					
1	C-100-14.1	Contractor Quality Control Program (CQCP) (Schedule II)	1	LS	
2	C-102-6.1	Storm Water Pollution Prevention Plan (Schedule II)	1	LS	
3	C-105-6.1	Mobilization (Schedule II)	1	LS	
4	GTP-10.01.1	Location of Underground Utilities (Schedule II)	1	LS	
5	GTP-20.04.1	Airfield Safety and Security (Airsides Work - Schedule II)	1	LS	
6	GTP-30.01.1	Riprap Underlain with Geosynthetic Filter Fabric (D50=6", T = 12")	179	SY	
7	P-152-4.1	Unclassified Excavation	3,000	CY	
8	D-701-5.1	24-inch RGRCP Storm Drain, Class III	308	LF	
9	D-701-5.2	30-inch RGRCP Storm Drain, Class III	140	LF	
10	D-701-5.3	42-inch RGRCP Storm Drain, Class III	328	LF	
11	D-751-5.1	Catch Basin (MAG Std Det 535, Type F)	2	EA	
12	D-751-5.2	Catch Basin (MAG Std Det 535, Type H)	1	EA	
13	D-751-5.3	Concrete Apron (ADOT Std Det C-15.80 - Dimensions Modified per Plan)	3	EA	
14	D-751-5.4	24-inch Flared End Section (MAG Std Det 545)	1	EA	
15	D-751-5.5	Storm Drain Manhole (MAG Std Det 520 & 423-2)	1	EA	
16	D-751-5.6	Connect Existing 42-inch Storm Drain to New Catch Basin	1	EA	

REVISION	BY	DATE
CITY OF PRESCOTT PRESCOTT REGIONAL AIRPORT		
PRC PROJECT NO 2024-066-11 DIBBLE PROJECT NO 1023143.11		
SAFE - OFF-SITE DRAINAGE IMPROVEMENTS		
ABBREVIATIONS, LEGEND, SHEET INDEX & QUANTITIES		
DRN: DSO	DES: MJH	CK: DHD
DATE: 04/2024	DATE: 04/2024	DATE: 04/2024
SCALE: NTS	CG1.1	2 OF 14



J:\2023\1023143.11_PRC_SAFE_DRAINAGE_IMPROVEMENTS\CAO\1023143.11-001_X - COVR.DWG Apr. 11, 2024 3:02 PM

PRC SAFE - OFF-SITE DRAINAGE IMPROVEMENTS, 100% SUBMITTAL, 4/11/2024

GENERAL NOTES

- 1. ALL CONSTRUCTION SHALL CONFORM TO MARICOPA ASSOCIATION OF GOVERNMENTS (MAG) & CITY OF PRESCOTT (COP) CONSTRUCTION STANDARDS & SPECIFICATIONS... 2. IT SHALL BE THE CONTRACTOR'S RESPONSIBILITY TO OBTAIN COPIES OF MAG AND CITY OF PRESCOTT STANDARDS AND SPECIFICATIONS... 3. ALL PLANS SIGNED BY THE CITY ENGINEER ARE NULL AND VOID ONE YEAR FROM DATE OF SIGNATURE IF CONSTRUCTION HAS NOT STARTED... 4. ALL QUANTITIES SHOWN ON THE PLANS ARE APPROXIMATE, ARE NOT VERIFIED BY THE PUBLIC WORKS DIRECTOR, AND ARE FURNISHED SOLELY FOR THE CONTRACTOR'S CONVENIENCE... 5. CITY OF PRESCOTT PUBLIC WORKS DEPARTMENT PERMIT(S) WILL BE REQUIRED FOR ALL OFF-SITE CONSTRUCTION AND CONSTRUCTION WITHIN PUBLIC RIGHT OF WAY OR EASEMENTS... 6. IT IS THE SOLE RESPONSIBILITY OF THE CONTRACTOR TO OBTAIN, AT HIS OWN EXPENSE, SUCH PERMITS AS ARE REQUIRED FROM THE APPROPRIATE AGENCIES... 7. THE PUBLIC WORKS DEPARTMENT SHALL BE NOTIFIED A MINIMUM OF 72 HOURS PRIOR TO BEGINNING ANY CONSTRUCTION (928)777-1140... 8. ANY WORK PERFORMED WITHOUT THE KNOWLEDGE AND APPROVAL OF THE PUBLIC WORKS DIRECTOR AND/OR ALL WORK MATERIALS NOT IN CONFORMANCE WITH THE PLANS AND SPECIFICATIONS IS SUBJECT TO REMOVAL AND REPLACEMENT AT THE CONTRACTOR'S EXPENSE... 9. A THOROUGH ATTEMPT HAS BEEN MADE TO SHOW THE LOCATION OF ALL UNDERGROUND OBSTRUCTIONS AND UTILITY LINES IN THE WORK AREA... 10. THE CONTRACTOR IS REQUIRED TO CONTACT ARIZONA 811 (1-800-782-5348) A MINIMUM OF TWO WORKING DAYS (48 HOURS) PRIOR TO COMMENCEMENT OF CONSTRUCTION... 11. THE CONTRACTOR SHALL BE RESPONSIBLE FOR COORDINATING THE RELOCATION AND/OR SUPPORT OF ALL UTILITIES, POWER POLES, ETC., THAT MAY BE NECESSARY... 12. THE CONTRACTOR SHALL BE RESPONSIBLE FOR SUBMITTING TO THE PUBLIC WORKS DEPARTMENT FOR APPROVAL, TRAFFIC CONTROL PLANS PRIOR TO BEGINNING CONSTRUCTION... 13. APPROPRIATE EMERGENCY AGENCIES SHALL BE NOTIFIED 24 HOURS PRIOR TO ANY CLOSING OF STREETS... 14. THE CONTRACTOR SHALL BE RESPONSIBLE FOR CONSTRUCTION SURVEYING AND LAYOUT WITH CONTROL PROVIDED BY THE DESIGN ENGINEER OR HIS DESIGNEE... 15. THE CONTRACTOR IS RESPONSIBLE FOR QUALITY CONTROL MEASURES SUFFICIENT TO PRODUCE MATERIALS AND WORKMANSHIP OF ACCEPTABLE QUALITY... 16. THE CONTRACTOR WILL BE RESPONSIBLE FOR ALL COSTS OF TESTING AND INSPECTION, INCLUDING THE PRESENCE OF CITY INSPECTORS, REQUIRED AT NIGHT OR ON WEEKENDS... 17. THE CONTRACTOR SHALL BE RESPONSIBLE FOR ALL RE-WORK AND/OR REMOVAL AND REPLACEMENT OF ALL MATERIALS REPRESENTED BY FAILING TESTS OR SUBSTANDARD WORKMANSHIP... 18. THE CONTRACTOR SHALL IMPLEMENT BEST-HOUSE-KEEPING MEASURES, AND EROSION AND SEDIMENT CONTROL MEASURES, TO PREVENT THE TRANSPORT OF CONSTRUCTION MATERIALS INTO DRAINAGE INLETS, STORM DRAIN MANHOLES, UTILITY STRUCTURES, OR ONTO ADJACENT STREETS AND PROPERTIES... 19. APPROVAL OF A PORTION OF THE WORK IN PROGRESS DOES NOT GUARANTEE ITS FINAL ACCEPTANCE... 20. THE CITY OF PRESCOTT MAY SUSPEND THE WORK BY WRITTEN NOTICE WHEN, IN ITS JUDGEMENT, PROGRESS IS UNSATISFACTORY... 21. ALL OBSTRUCTIONS IN THE RIGHT-OF-WAY SHALL BE REMOVED BEFORE ANY CONSTRUCTION IS PERMITTED... 22. REMOVAL OF STRUCTURES AND OBSTRUCTIONS AS NECESSARY TO COMPLETE THE WORK, OTHER THAN SPECIFICALLY SCHEDULED IN THE BID, IS INCIDENTAL TO THE CONTRACT...

GENERAL NOTES (CONT)

- 23. CLEARING AND GRUBBING IS CONSIDERED INCIDENTAL TO THE WORK UNLESS SCHEDULED IN THE BID... 24. THE CONTRACTOR SHALL GUARD AGAINST DAMAGE DURING CONSTRUCTION TO EXISTING PROPERTIES AND IMPROVEMENTS... 25. THE CONTRACTOR SHALL KEEP SUITABLE EQUIPMENT ON HAND AT THE JOBSITE FOR MAINTAINING DUST CONTROL... 26. STREET AND TRAFFIC SIGNS WILL BE RELOCATED BY THE CONTRACTOR... 27. BACKFILL COMPACTION SHALL BE TYPE I (MAG, SECTION 601) UNLESS OTHERWISE NOTED WITHIN THE PLANS OR SPECIFICATIONS... 28. AGGREGATE BASE COURSE SHALL NOT BE PLACED ON SUBGRADE UNTIL SUBGRADE REQUIREMENTS HAVE BEEN ACHIEVED... 29. NO PAVING CONSTRUCTION SHALL BE STARTED UNTIL ALL UNDERGROUND UTILITIES WITHIN THE ROADWAY PRISM ARE VERIFIED... 30. ALL AC PAVEMENT SECTIONS ARE SHOWN IN THE PLANS... 31. ALL UTILITY FRAMES, COVERS, VALVE BOXES, MANHOLES, ETC. SHALL BE ADJUSTED TO FINISH ASPHALT GRADE... 32. ALL DISTURBED FENCES SHALL BE REPLACED IN KIND... 33. ACCEPTANCE OF THE COMPLETED PAVING STRUCTURE WILL NOT BE GIVEN UNTIL REPRODUCIBLE "AS-BUILT" PLANS HAVE BEEN SUBMITTED... 34. ALL CONCRETE TO BE AT LEAST 3000 PSI CLASS "A" PORTLAND CEMENT CONCRETE... 35. EDGES OF CONCRETE STRUCTURES TO HAVE A 3/4" CHAMFER... 36. CONCRETE SURFACES TO HAVE A BROOM FINISH... 37. ALL EXPANSION JOINTS TO BE SEALED WITH 1/2" EXPANSION JOINT, PRE-FORMED JOINT FILLER AND SEALER... 38. NO JOB WILL BE CONSIDERED COMPLETE UNTIL ALL OFFSITE CURBS, PAVEMENT AND SIDEWALKS HAVE BEEN SWEEP CLEAN... 39. CONTRACTOR/DEVELOPER SHALL WARRANT ALL WORK FOR A MINIMUM OF A TWO YEAR PERIOD... 40. THE CONTRACTOR IS RESPONSIBLE FOR AND SHALL TAKE PRECAUTIONS TO PROTECT THE WORK AND MATERIALS ASSOCIATED WITH THESE PLANS... 41. THE CONTRACTOR IS RESPONSIBLE FOR ALL CONSTRUCTION SURVEY AND STAKING.

GRADING AND DRAINAGE NOTES

- 1. ALL GRADING SHALL CONFORM TO THE CURRENT CITY ADOPTED EDITION OF THE INTERNATIONAL BUILDING CODE, & CITY OF PRESCOTT LAND DEVELOPMENT CODE... 2. ALL PROVISIONS OF THE SOILS REPORT PREPARED BY _____ DATED _____ SHALL BE COMPLIED WITH DURING OPERATIONS... 3. THIS PLAN IS FOR GRADING PURPOSES ONLY... 4. CERTIFICATION FROM THE REGISTERED CIVIL ENGINEER & SOILS/GEOTECHNICAL ENGINEER STATING THAT THE ROUGH GRADING HAS BEEN COMPLETED... 5. PARTIES NAMED ON ADEQ'S NOTICE OF INTENT (N.O.I) ARE RESPONSIBLE FOR EROSION, DUST, MUD, SILT, DEBRIS, & TEMPORARY DRAINAGE CONTROL... 6. ANY ON-SITE RETAINING WALLS WILL REQUIRE APPROVAL AS PART OF THESE PLANS... 7. ANY INFRASTRUCTURE CONSTRUCTED IN THE PUBLIC RIGHT OF WAY WILL REQUIRE SEPARATE PLAN APPROVAL... 8. ANY WALLS, FENCES, STRUCTURES AND/OR APPURTENANCES ADJACENT TO THIS PROJECT SHALL BE PROTECTED IN PLACE... 9. THE CONTRACTOR/DEVELOPER IS RESPONSIBLE FOR ENSURING THAT RETAINING WALLS DO NOT INTERFERE WITH PROVISION OF UTILITIES... 10. IT IS THE CONTRACTOR'S RESPONSIBILITY TO ENSURE THAT COMPACTION HAS BEEN ATTAINED ON THE ENTIRE GRADING SITE... 11. CITY APPROVAL OF PLANS DOES NOT RELIEVE THE DEVELOPER FROM THE RESPONSIBILITY FOR CORRECTION OR ERROR OR OMISSION DISCOVERED DURING CONSTRUCTION... 12. IT SHALL BE THE CONTRACTOR'S RESPONSIBILITY TO CALL THE CITY ENGINEER'S OFFICE AT (928) 777-1140 FOR ANY REQUIRED CIVIL INSPECTION... 13. NO GRADING SHALL COMMENCE WITHOUT OBTAINING A GRADING PERMIT & NOTIFYING THE CITY OF PRESCOTT OR DEVELOPER'S GRADING INSPECTOR... 14. PRIOR TO THE START OF GRADING ALL SWPPP MEASURES SHALL BE IN PLACE... 15. AFTER REMOVAL OF DEBRIS, ANY EXISTING FILL OR DISTURBED NATURAL SOILS SHALL BE EXCAVATED TO THE SATISFACTION OF THE SOILS ENGINEER... 16. THE EXPOSED SOILS SHALL THEN BE INSPECTED BY THE SOILS ENGINEER... 17. THE EXPOSED SOILS SHALL THEN BE SCARIFIED TO PROVIDE A BOND WITH NEW FILL... 18. THE SOILS & DESIGN ENGINEER OF RECORD SHALL ALSO BE RESPONSIBLE TO INSPECT, VERIFY & REPORT THAT PROPER COMPACTION HAS BEEN OBTAINED... 19. AN AS-GRADED GRADING PLAN & THE CERTIFICATION OF COMPLIANCE FORMS FOR SAID GRADING PLAN... 20. NO FILL SHALL BE PLACED UNTIL STRIPPING OF VEGETATION, REMOVAL OF UNSUITABLE SOILS, & INSTALLATION OF SUBDRAINS (IF ANY) HAVE BEEN INSPECTED & APPROVED BY THE SOILS ENGINEER... 21. CONTRACTOR MUST SET GRADE STAKES FOR ALL DRAINAGE DEVICES & OBTAIN INSPECTION BEFORE POURING... 22. GRADING SHALL NOT BE STARTED WITHOUT FIRST NOTIFYING CITY PUBLIC WORKS INSPECTION DEPARTMENT... 23. ALL EXISTING FILLS SHALL BE APPROVED & CERTIFIED BY THE SOILS ENGINEER OR REMOVED PRIOR TO PLACING ADDITIONAL FILLS... 24. ALL TRENCH BACKFILLS SHALL BE TESTED & APPROVED BY THE SOILS ENGINEER.

GRADING AND DRAINAGE NOTES (CONT)

- 25. THE COMPACTION REPORT & APPROVAL FROM THE SOILS ENGINEER SHALL INDICATE THE TYPE OF FIELD TESTING PERFORMED... 26. EXPORT SOIL MUST BE TRANSPORTED TO A LEGAL DUMP OR TO A PERMITTED SITE SHOWN CLEARLY ON APPROVED PLANS... 27. ALL EXISTING DRAINAGE COURSES THROUGH THE SITE SHALL REMAIN OPEN UNTIL FACILITIES TO HANDLE STORM WATER ARE APPROVED & FUNCTIONAL...

EROSION SEDIMENTATION CONTROL NOTES

- 1. A COPY OF THE APPROVED GRADING AND DRAINAGE PLAN FOR THIS PROJECT AND EROSION AND SEDIMENT CONTROL (ESC) PLAN OR STORM WATER POLLUTION PREVENTION PLAN (SWPPP) SHALL BE MAINTAINED ON THE SITE... 2. THE ESC/SWPPP AND RELATED RECORDS MUST BE MADE AVAILABLE UPON REQUEST TO ADEQ AND THE CITY OF PRESCOTT... 3. THE IMPLEMENTATION OF THESE PLANS AND CONSTRUCTION, MAINTENANCE, REPLACEMENT, AND UPGRADING OF THESE FACILITIES IS THE RESPONSIBILITY OF THE PERMITTEE/CONTRACTOR... 4. THE SCHEMATIC EROSION CONTROL MEASURES SHOWN ON THE PLANS ARE A MINIMUM... 5. CONTRACTOR SHALL PERMANENTLY STABILIZE ALL DISTURBED SLOPES AS STATED ON APPROVED CONSTRUCTION PLANS... 6. CONTRACTOR SHALL TAKE MEASURES TO PREVENT OR MINIMIZE THE GENERATION, EMISSION AND/OR TRANSPORT OF FUGITIVE DUST... 7. THIS PLAN SHALL BE IN EFFECT UNTIL ALL DISTURBED AREAS ARE PERMANENTLY STABILIZED... 8. A CONCRETE WASHOUT SHALL BE INSTALLED FOR ALL PROJECTS THAT PROPOSE CONCRETE TO BE MIXED ON SITE...

AS BUILT DATE
DIBBLE
47425 DUANE H. DANA

Table with 2 columns: REVISION, BY, DATE. Includes project info: CITY OF PRESCOTT, PRESCOTT REGIONAL AIRPORT, PRC PROJECT NO 2024-066-11, DIBBLE PROJECT NO 1023143.11, SAFE - OFF-SITE DRAINAGE IMPROVEMENTS.

Table with 2 columns: DRAWING, SHEET. Includes project info: GENERAL NOTES, SCALE: NTS, CG1.2, 3 OF 14.



J:\2023\1023143.11_PRC_SAFE_DRAINAGE_IMPROVEMENTS\CAD\1023143_11-CG1_X - COVR.DWG Apr. 11, 2024 3:02 PM

PRC SAFE - OFF-SITE DRAINAGE IMPROVEMENTS, 100% SUBMITTAL, 4/11/2024

THE SURVEY DATA USED FOR DESIGN MEETS (OR EXCEEDS) THE CRITERIA OF A LEVEL 1A SURVEY AS FOLLOWS

HORIZONTAL		VERTICAL	
CODE	TOLERANCE	CODE	TOLERANCE
1	+20FT (6 M)	A	+3FT (1 M)

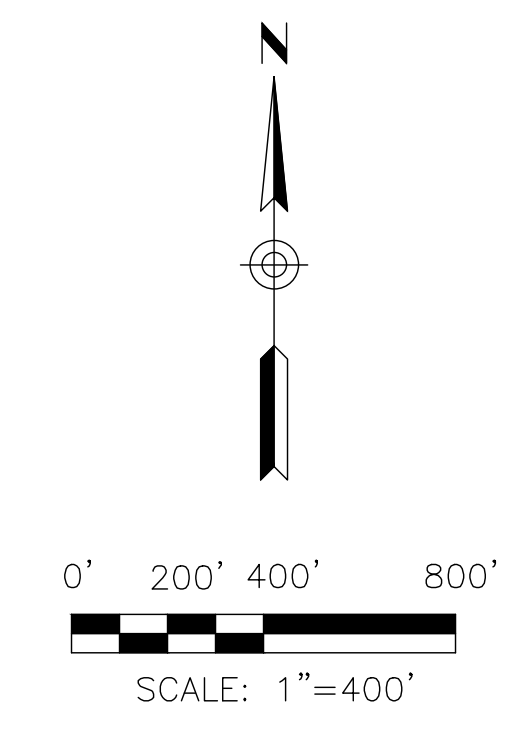

POINT DATA TABLE				
POINT NO	GROUND NORTHING	GROUND EASTING	ELEVATION	DESCRIPTION
1	1329576.560	546305.370	5015.39	FND-BCHH PRC C
5	1330660.861	548503.036	4975.03	FND-NAIL PK
7	1334285.265	551717.584	4937.83	FND-TAG 2012
102	1328014.976	547816.366	5004.92	FND-IB PRC B
103	1334185.111	551292.788	4938.74	FND-BCHH PRC D

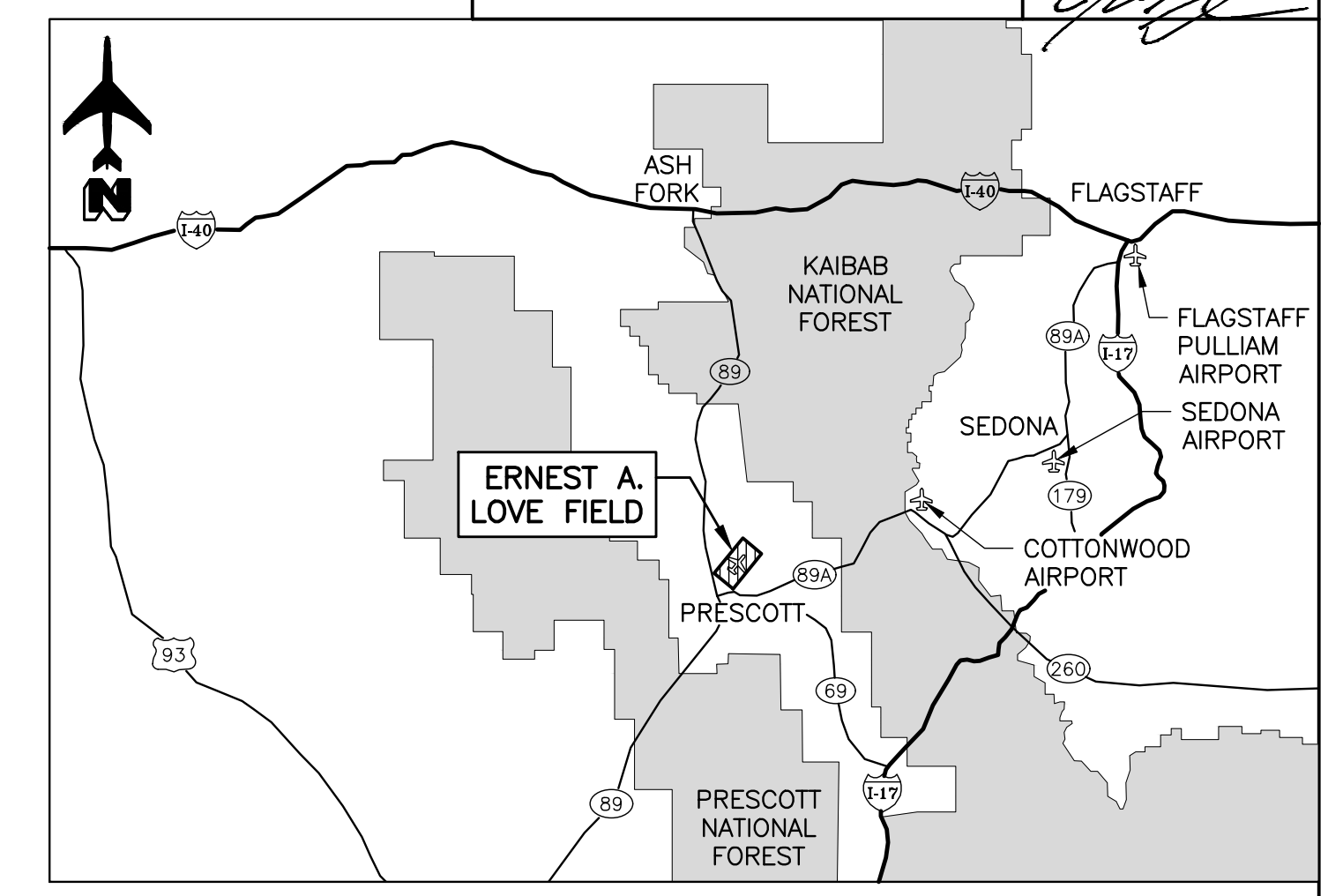

SURVEYOR'S NOTES

- COORDINATES WERE VERIFIED IN THE FIELD USING REAL TIME KINEMATIC GPS OBSERVATIONS RELATIVE TO NGS PUBLISHED CONTROL POINTS.
- SURVEYED DURING THE MONTH OF MAY 2023.
- CONTRACTOR SHALL VERIFY HORIZONTAL AND VERTICAL CONTROLS IN THE FIELD PRIOR TO CONSTRUCTION.
- PROJECT META DATA
UNITS:
COORDINATES, DISTANCES AND ELEVATIONS ARE SHOWN IN INTERNATIONAL FEET.

HORIZONTAL DATUM:
NAD83 (2011 Epoch) ARIZONA CENTRAL ZONE

HORIZONTAL ADJUSTMENT (GROUND TO GRID)
GRID NORTHING = (GROUND NORTHING X 0.999670134)
GRID EASTING = (GROUND EASTING X 0.999670134)

HORIZONTAL ADJUSTMENT TO CITY OF PRESCOTT DATUM:
NORTHING = (GRID NORTHING X 1.000329975) - 701,456.009
EASTING = (GRID EASTING X 1.000329975) + 69,457.249

VERTICAL DATUM:
NAVD '88

PRIMARY BENCHMARK:
POINT NUMBER 102 PRC B
DESCRIPTION: STEEL ROD WITH PUNCH MARK IN HANDHOLE
ELEVATION = 5004.92

SECONDARY BENCHMARK:
POINT NUMBER 1 PRC C
DESCRIPTION: NGS BRASS CAP IN HANDHOLE STAMPED "NATIONAL GEODETIC SURVEY 1996"
ELEVATION = 5015.39

SECONDARY BENCHMARK:
POINT NUMBER 103 PRC D
DESCRIPTION: NGS BRASS CAP IN HANDHOLE STAMPED "NATIONAL GEODETIC SURVEY 1996"
PUBLISHED ELEVATION = 4938.78
OBSERVED ELEVATION = 4938.74
- THE COORDINATES PRESENTED ARE SHOWN TO THREE DECIMAL PLACES FOR CALCULATION PURPOSES AND ARE NOT REPRESENTATIVE OF THE PRECISION OF THE SURVEY MEASUREMENTS
- THIS IS NOT A PROPERTY BOUNDARY SURVEY.

LEGEND

- FOUND BRASS CAP IN HANDHOLE
- ▲ FOUND NAIL
- ▲ PRIMARY BENCHMARK
- FND-BM FOUND BENCHMARK
- FND-BCF FOUND BRASS CAP FLUSH
- FND-IB FOUND IRON BAR (STEEL ROD)
- FND-BCHH FOUND BRASS CAP IN HANDHOLE
- FND-TAG FOUND TAG
- FND-NAIL FOUND PK NAIL

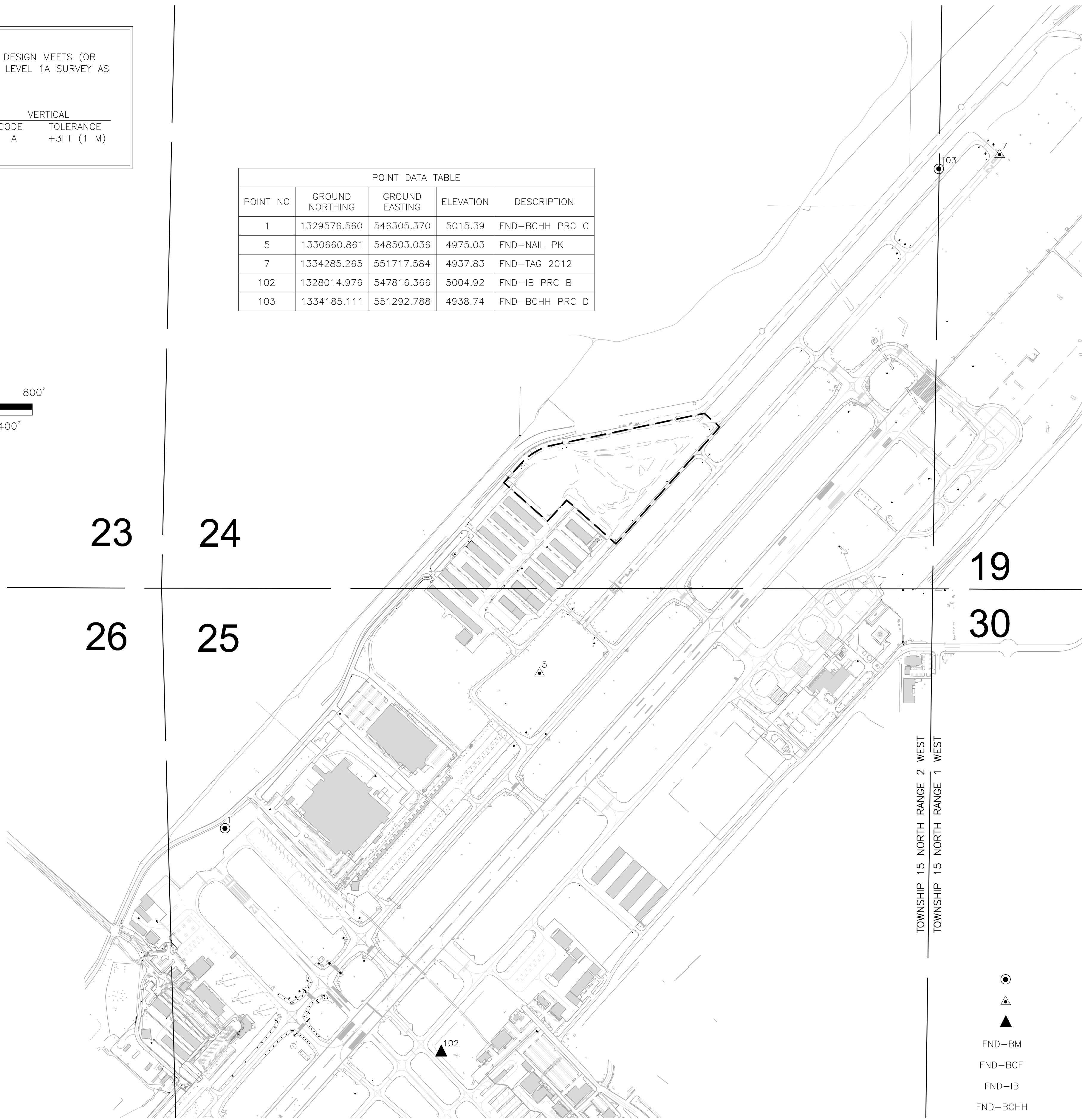

REVISION		BY	DATE
EMBRY-RIDDLE AERONAUTICAL UNIVERSITY			
ERAU PROJECT NO. 2024-066-11		DIBBLE PROJECT NO. 1023143.11	
SAFE - OFF-SITE DRAINAGE IMPROVEMENTS			
SURVEY CONTROL PLAN			
DRN:JLB	DES:JLB	CK:JPG	DRAWING
DATE:12/23	DATE:12/23	DATE:12/23	SHEET
SCALE: 1" = 400'		CG1.3	4 OF 14



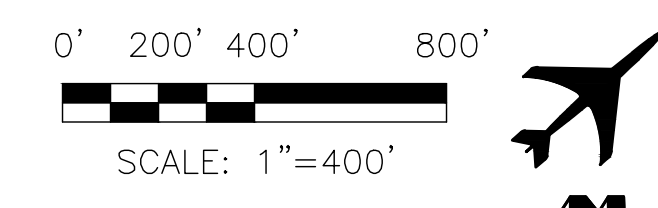

AS BUILT DATE
DIBBLE

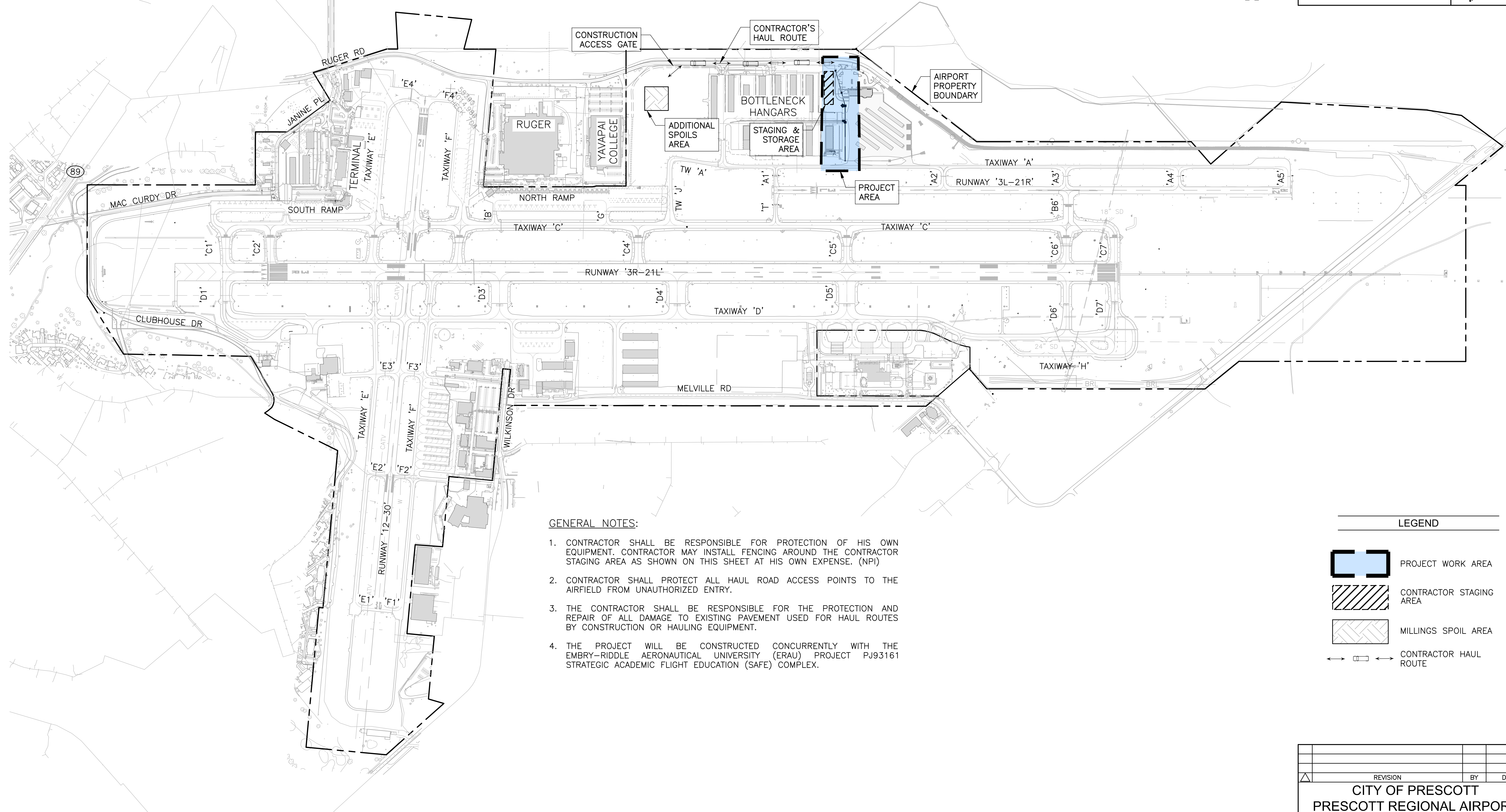

GENERAL NOTES:

1. CONTRACTOR SHALL BE RESPONSIBLE FOR PROTECTION OF HIS OWN EQUIPMENT. CONTRACTOR MAY INSTALL FENCING AROUND THE CONTRACTOR STAGING AREA AS SHOWN ON THIS SHEET AT HIS OWN EXPENSE. (NPI)
2. CONTRACTOR SHALL PROTECT ALL HAUL ROAD ACCESS POINTS TO THE AIRFIELD FROM UNAUTHORIZED ENTRY.
3. THE CONTRACTOR SHALL BE RESPONSIBLE FOR THE PROTECTION AND REPAIR OF ALL DAMAGE TO EXISTING PAVEMENT USED FOR HAUL ROUTES BY CONSTRUCTION OR HAULING EQUIPMENT.
4. THE PROJECT WILL BE CONSTRUCTED CONCURRENTLY WITH THE EMBRY-RIDDLE AERONAUTICAL UNIVERSITY (ERAU) PROJECT PJ93161 STRATEGIC ACADEMIC FLIGHT EDUCATION (SAFE) COMPLEX.

LEGEND

- PROJECT WORK AREA
- CONTRACTOR STAGING AREA
- MILLINGS SPOIL AREA
- CONTRACTOR HAUL ROUTE

J:\2023\1023143.11_PRC_SAFE_DRAINAGE_IMPROVEMENTS\CAD\1023143.11-CG1.X - COVR.DWG Apr. 11, 2024 3:02 PM

REVISION	BY	DATE
CITY OF PRESCOTT PRESCOTT REGIONAL AIRPORT		
PRC PROJECT NO 2024-066-11		DIBBLE PROJECT NO 1023143.11
SAFE - OFF-SITE DRAINAGE IMPROVEMENTS		
AIRPORT & PROJECT SITE PLAN		
DRN: DSO	DES: MJH	CK: DHD
DATE: 04/2024	DATE: 04/2024	DATE: 04/2024
SCALE: 1" = 400'	DRAWING	SHEET
	CG1.4	5 OF 14



PRC SAFE - OFF-SITE DRAINAGE IMPROVEMENTS, 100% SUBMITTAL, 4/11/2024

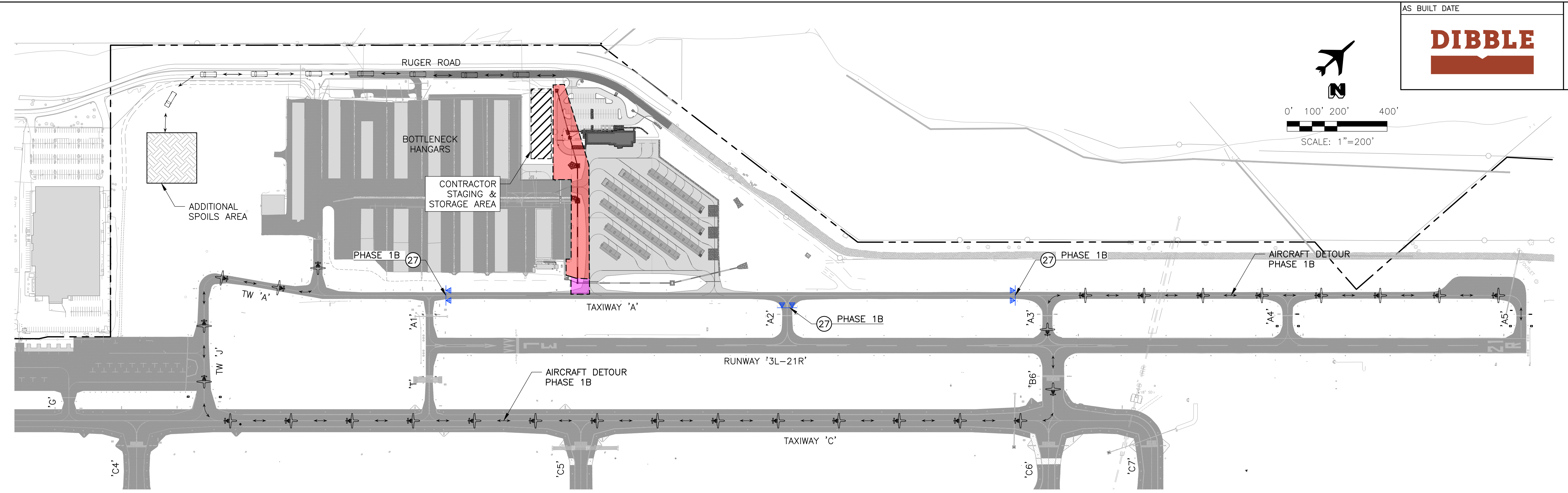
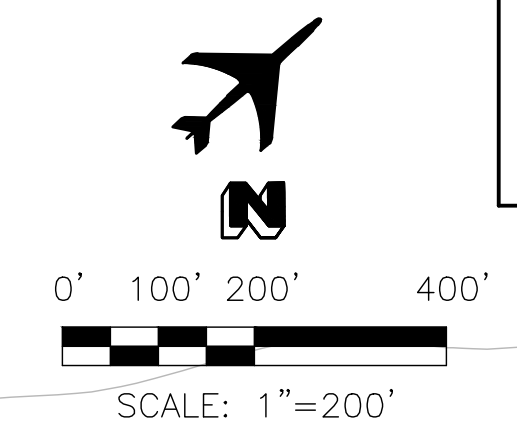

GENERAL NOTES:

1. CONTRACTOR SHALL BE RESPONSIBLE FOR PROTECTION OF HIS OWN EQUIPMENT. CONTRACTOR MAY INSTALL FENCING AROUND THE CONTRACTOR STAGING AREA AS SHOWN ON THIS SHEET AT HIS OWN EXPENSE. (NPI)
2. CONTRACTOR SHALL PROTECT ALL HAUL ROAD ACCESS POINTS TO THE AIRFIELD FROM UNAUTHORIZED ENTRY.
3. CONTRACTOR SHALL BE RESPONSIBLE FOR PROVIDING THE INCIDENTAL GRADING AND INFRASTRUCTURE NECESSARY FOR THE TEMPORARY HAUL ROADS. ANY DISTURBED AREA SHALL BE RETURNED TO A CONDITION THAT IS EQUAL TO OR BETTER THAN ITS ORIGINAL CONDITION, TO THE SATISFACTION OF THE AIRPORT.
4. THE CONTRACTOR SHALL BE RESPONSIBLE FOR THE PROTECTION AND REPAIR OF ALL DAMAGE TO EXISTING PAVEMENT USED FOR HAUL ROUTES BY CONSTRUCTION OR HAULING EQUIPMENT.

PROJECT ELEMENTS:

PROJECT ELEMENTS:	DURATION:
PHASE 1A DRAINAGE IMPROVEMENTS	60 CAL. DAYS
PHASE 1B CONSTRUCTION IMPACTING TAXIWAY 'A' TOFA REQUIRING ITS CLOSURE: DRAINAGE IMPROVEMENTS	14 CAL. DAYS CONCURRENT W/PHASE 1A
TOTAL	60 CAL. DAYS

LEGEND

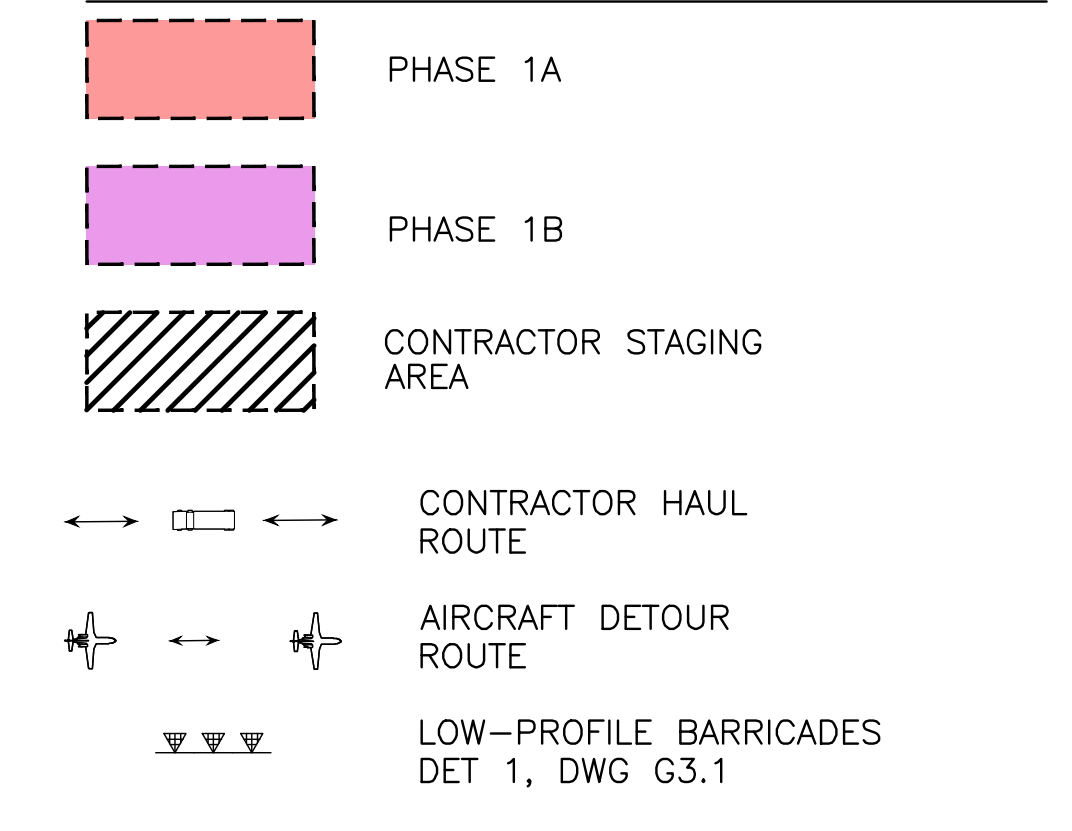

CONSTRUCTION NOTES

- (27) LOW-PROFILE BARRICADES
DET 1, DWG G3.1

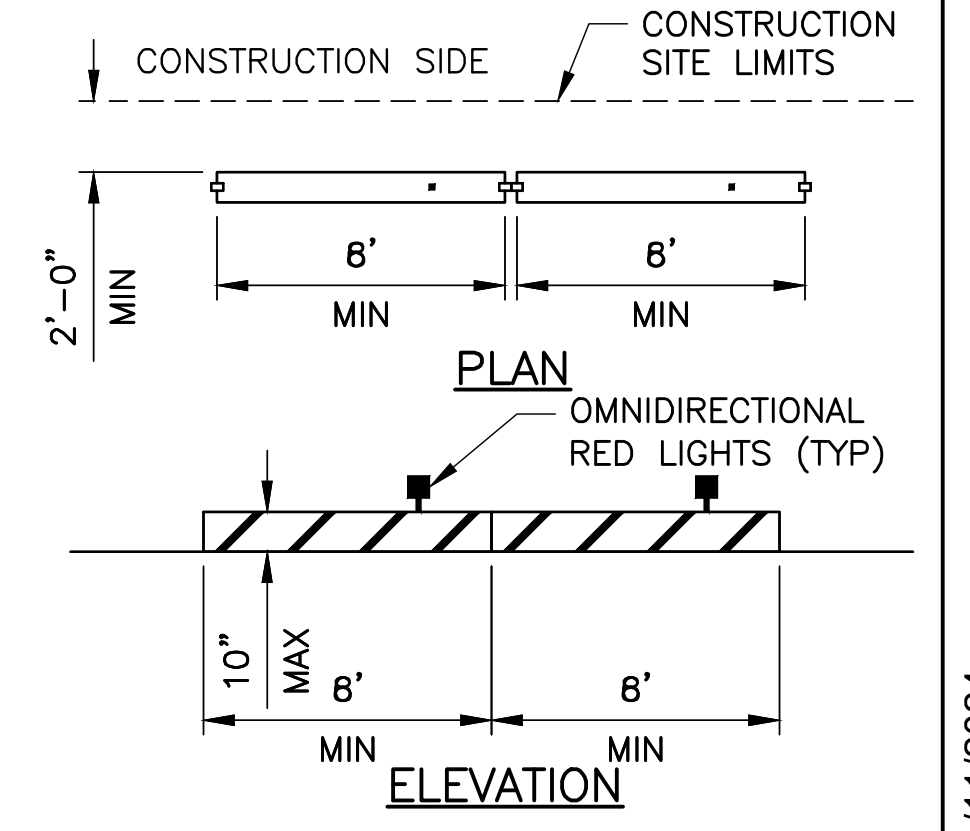

NOTES:

1. LOW PROFILE BARRICADES AND LIGHTS SHALL BE PROVIDED AND MAINTAINED (DAY AND NIGHT) BY THE CONTRACTOR (NPI).
2. THE OWNER MAY DIRECT THE CONTRACTOR TO RELOCATE ANY BARRICADES AT THEIR DISCRETION AT NO ADDITIONAL COST TO OWNER.

1 LOW PROFILE BARRICADES
NO SCALE

REVISION	BY	DATE
CITY OF PRESCOTT PRESCOTT REGIONAL AIRPORT		
PRC PROJECT NO 2024-066-11 DIBBLE PROJECT NO 1023143.11		
SAFE - OFF-SITE DRAINAGE IMPROVEMENTS		
CONSTRUCTION PHASING PLAN OVERALL		
DRN: DSO	DES: MJH	CK: DHD
DATE: 04/2024	DATE: 04/2024	DATE: 04/2024
SCALE: 1"=200'	DRAWING	SHEET
	CG2.1	6 OF 14



J:\2023\1023143.11_PRC_SAFE_DRAINAGE_IMPROVEMENTS\CAO\1023143.11-02-X - PHAS.DWG Apr. 11, 2024 3:03 PM

PRC SAFE - OFF-SITE DRAINAGE IMPROVEMENTS, 100% SUBMITTAL, 4/11/2024

J:\2023\1023143.11_PRC_SAFE_DRAINAGE_IMPROVEMENTS\CA0\1023143.11-02_X - PHAS.DWG Apr. 11, 2024 3:03 PM

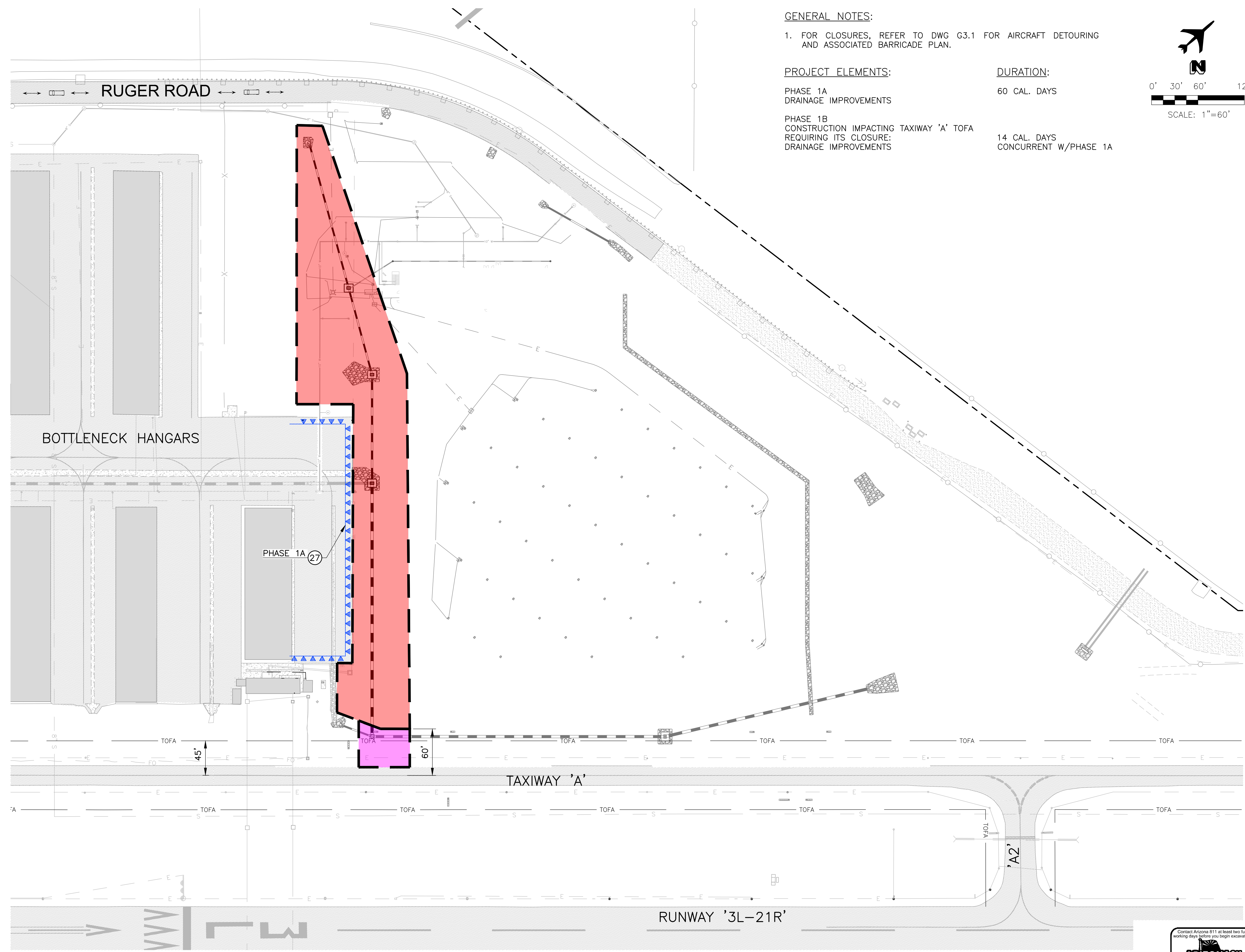

GENERAL NOTES:
 1. FOR CLOSURES, REFER TO DWG G3.1 FOR AIRCRAFT DETOURING AND ASSOCIATED BARRICADE PLAN.

PROJECT ELEMENTS:
 PHASE 1A
 DRAINAGE IMPROVEMENTS

DURATION:
 60 CAL. DAYS

PHASE 1B
 CONSTRUCTION IMPACTING TAXIWAY 'A' TOFA
 REQUIRING ITS CLOSURE:
 DRAINAGE IMPROVEMENTS

DURATION:
 14 CAL. DAYS
 CONCURRENT W/PHASE 1A

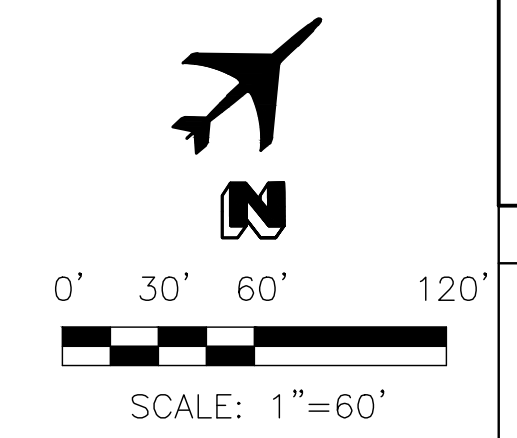

AS BUILT DATE		
LEGEND		
	PHASE 1A	
	PHASE 1B	
	CONTRACTOR HAUL ROUTE	
	AIRCRAFT DETOUR ROUTE	
	LOW-PROFILE BARRICADES DET 1, DWG G3.1	
CONSTRUCTION NOTES		
(27)	LOW-PROFILE BARRICADES DET 1, DWG G3.1	

REVISION	BY	DATE
CITY OF PRESCOTT PRESCOTT REGIONAL AIRPORT		
PRC PROJECT NO 2024-066-11		DIBBLE PROJECT NO 1023143.11
SAFE - OFF-SITE DRAINAGE IMPROVEMENTS		
CONSTRUCTION PHASING PLAN PHASE 1		
DRN: DSO	DES: MJH	CK: DHD
DATE: 04/2024	DATE: 04/2024	DATE: 04/2024
SCALE: 1"=60'	DRAWING CG2.2	SHEET 7 OF 14



PRC SAFE - OFF-SITE DRAINAGE IMPROVEMENTS, 100% SUBMITTAL, 4/11/2024

J:\2023\1023143.11_PRC_SAFE_DRAINAGE_IMPROVEMENTS\CAO\1012143_11-GD1.0 - GRAD_COVRL.DWG Apr. 11, 2024 3:05 PM

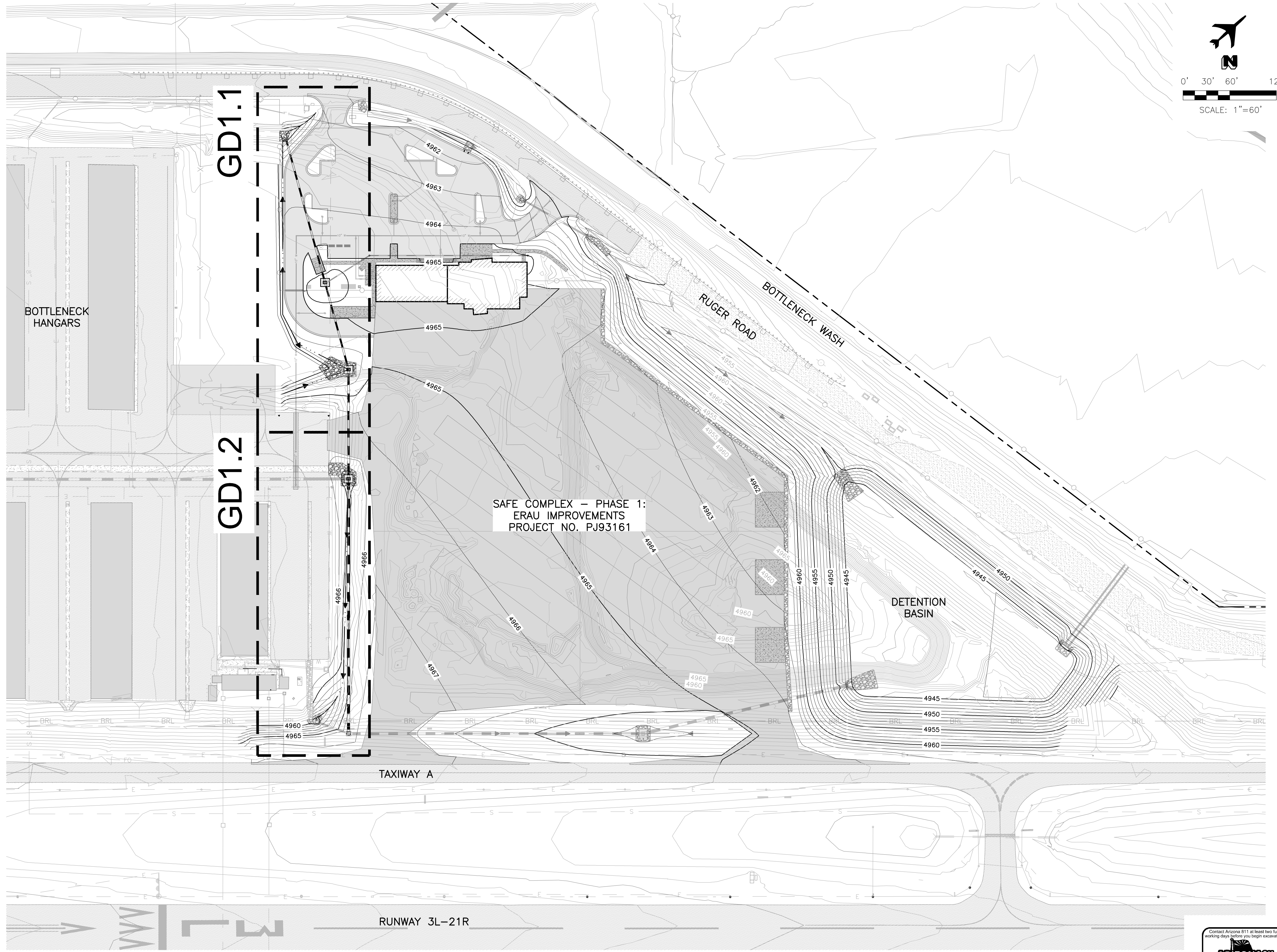

AS BUILT DATE

DIBBLE

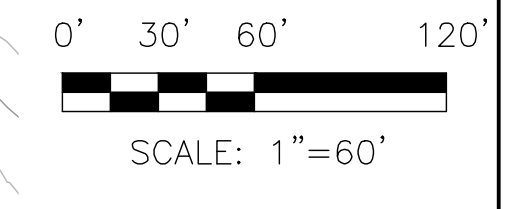

GD1.1

GD1.2

SAFE COMPLEX - PHASE 1:
ERAU IMPROVEMENTS
PROJECT NO. PJ93161

BOTTLENECK
HANGARS

RUGER ROAD
BOTTLENECK WASH

DETENTION
BASIN

TAXIWAY A

RUNWAY 3L-21R

REVISION	BY	DATE
CITY OF PRESCOTT PRESCOTT REGIONAL AIRPORT PRC PROJECT NO 2024-066-11 DIBBLE PROJECT NO 1023143.11 SAFE - OFF-SITE DRAINAGE IMPROVEMENTS GRADING & DRAINAGE OVERALL PLAN		
DRN: DSO	DES: MJH	CK: DHD
DATE: 04/2024	DATE: 04/2024	DATE: 04/2024
SCALE:	GD1.0	8 OF 14



PRC SAFE - OFF-SITE DRAINAGE IMPROVEMENTS, 100% SUBMITTAL, 4/11/2024

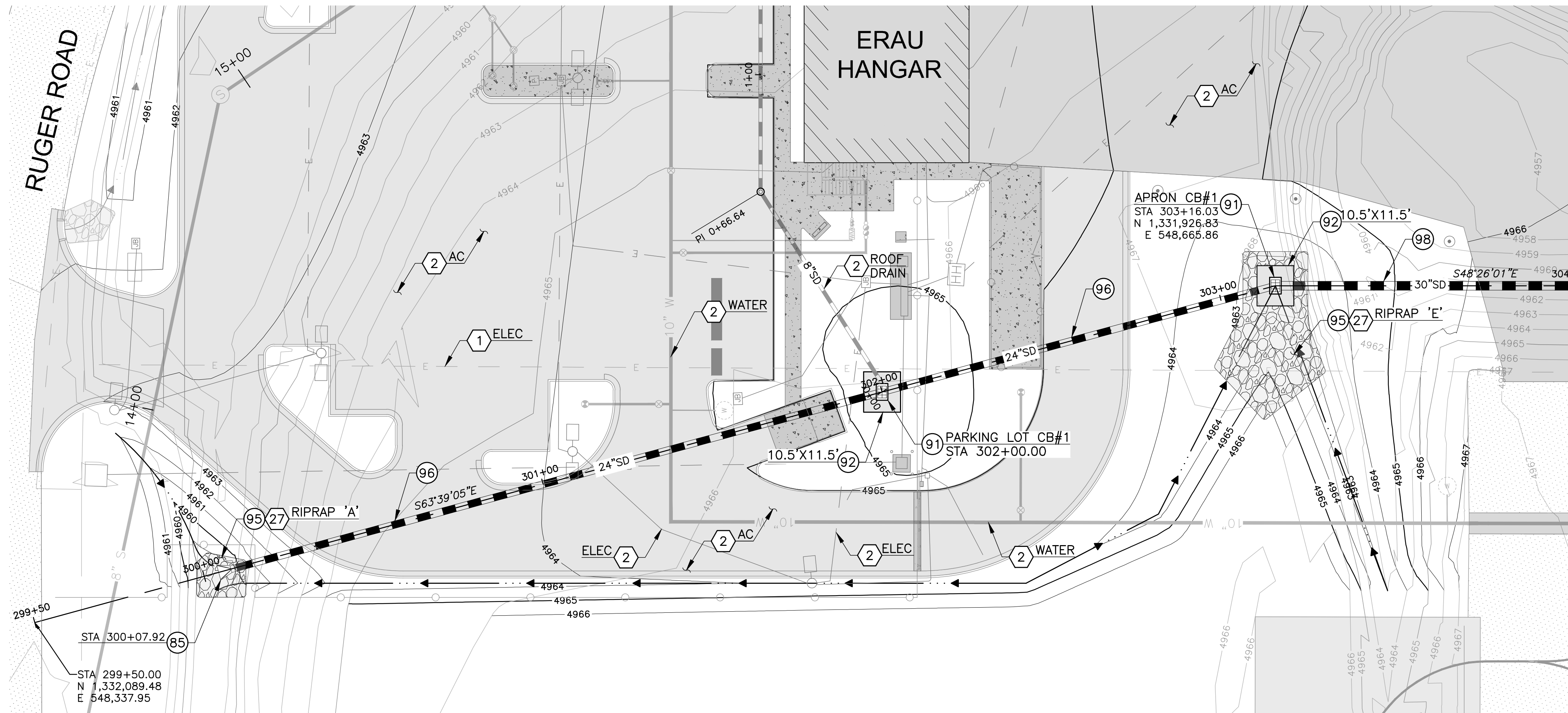

MATCH LINE STA 304+00 SEE DWG GD1.1

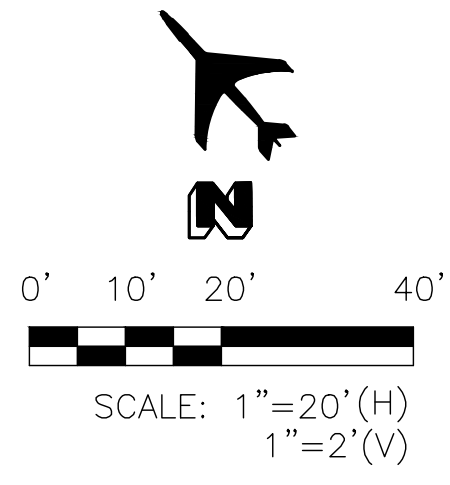

AS BUILT DATE

CONSTRUCTION NOTES		
85	24" FLARED END SECTION MAG STD DET 545	1 EA
91	CATCH BASIN MAG STD DET 535, TYPE F	2 EA
92	CONCRETE APRON ADOT STD DET C-15.80 (MODIFIED)	2 EA
95	RIPRAP W/ GEOSYNETHIC FILTER FABRIC D50=6", T=12" DET 1, DWG GD2.1	110 SY
96	24" RGRCP STORM DRAIN, CLASS III	308 LF
98	30" RGRCP STORM DRAIN, CLASS III	84 LF

REFERENCE NOTES	
1	PROTECT IN PLACE
2	SAFE COMPLEX IMPROVEMENTS REFER TO ERAU PROJECT NUMBER PJ93161
27	REFER TO DWG GD2.2 FOR RIPRAP DIMENSIONS

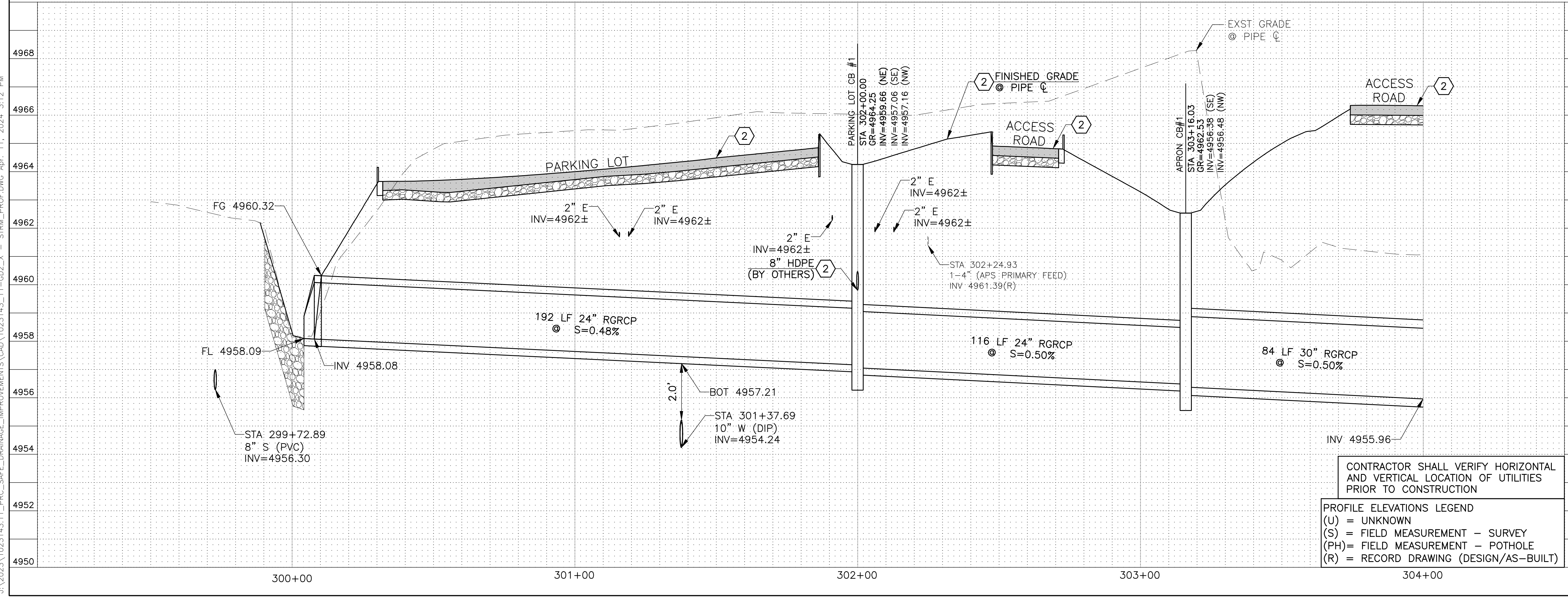

CONTRACTOR SHALL VERIFY HORIZONTAL AND VERTICAL LOCATION OF UTILITIES PRIOR TO CONSTRUCTION

PROFILE ELEVATIONS LEGEND
 (U) = UNKNOWN
 (S) = FIELD MEASUREMENT - SURVEY
 (PH) = FIELD MEASUREMENT - POT HOLE
 (R) = RECORD DRAWING (DESIGN/AS-BUILT)

REVISION	BY	DATE

**CITY OF PRESCOTT
PRESCOTT REGIONAL AIRPORT**

PRC PROJECT NO 2024-066-11 DIBBLE PROJECT NO 1023143.11

SAFE - OFF-SITE DRAINAGE IMPROVEMENTS

**STORM DRAIN
PLAN & PROFILE 1**

DRN: DSO	DES: MJH	CK: DHD	DRAWING	SHEET
DATE: 04/2024	DATE: 04/2024	DATE: 04/2024	GD1.1	9 OF 14

SCALE: 1"=20'(H) 1"=2'(V)

J:\2023\1023143.11_PRC_SAFE_DRAINAGE_IMPROVEMENTS\CAD\1023143_11-GD2_X - STRM_PROF.DWG Apr. 11, 2024 3:12 PM

PRC SAFE - OFF-SITE DRAINAGE IMPROVEMENTS, 100% SUBMITTAL, 4/11/2024

MATCH LINE STA 304+00 SEE DWG GD1.2

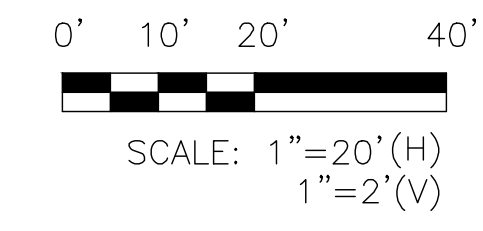
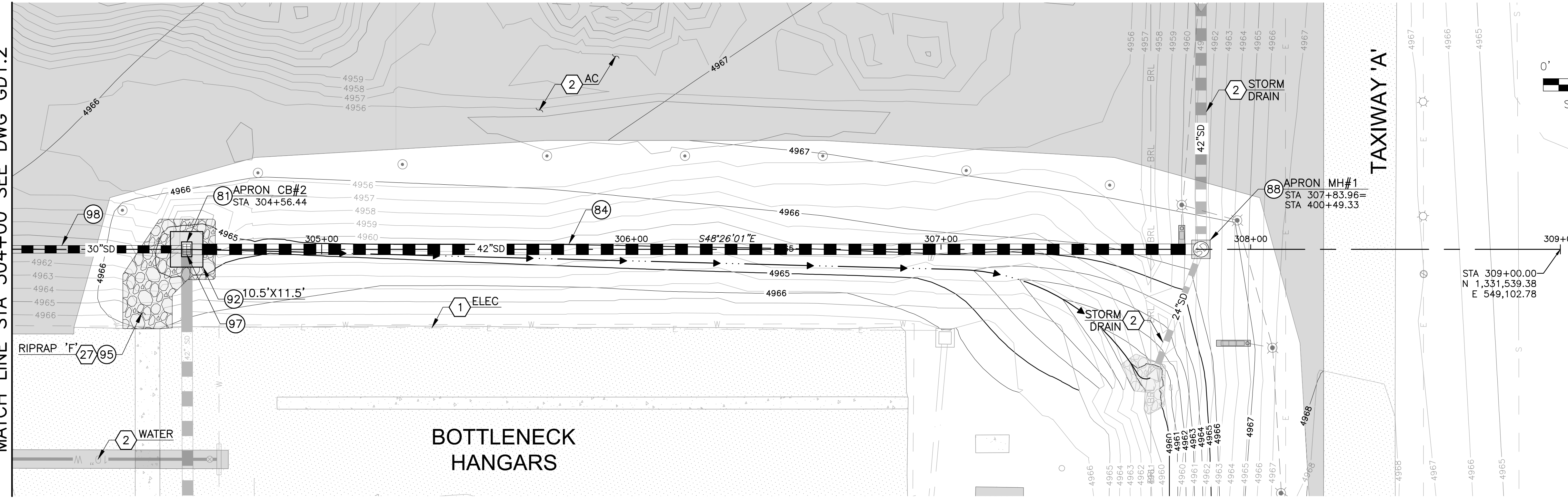

AS BUILT DATE

DIBBLE

47425
DUANE H.
DANA

CONSTRUCTION NOTES

81	CATCH BASIN MAG STD DET 538, TYPE H	1 EA
84	42" RGRCP STORM DRAIN, CLASS III	328 LF
88	STORM DRAIN MANHOLE MAG STD DET 520 & 423-2	1 EA
92	CONCRETE APRON ADOT STD DET C-15.80 (MODIFIED)	1 EA
95	RIPRAP W/ GEOSYNETHIC FILTER FABRIC D50=6", T=12" DET 1, DWG GD2.1	69 SY
97	CONNECT EXST 42-INCH STORM DRAIN TO NEW CATCH BASIN	1 EA
98	30" RGRCP STORM DRAIN, CLASS III	56 LF

REFERENCE NOTES

1	PROTECT IN PLACE
2	SAFE COMPLEX IMPROVEMENTS REFER TO ERAU PROJECT NUMBER PJ93161

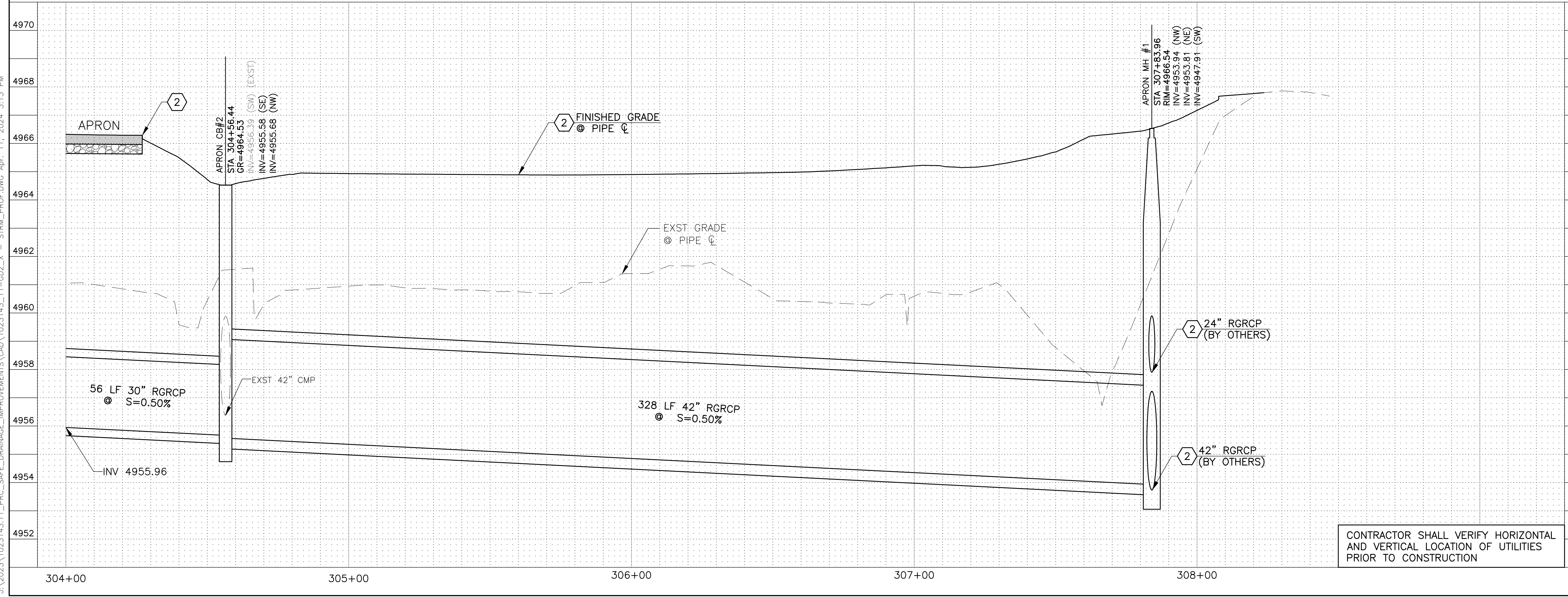

CONTRACTOR SHALL VERIFY HORIZONTAL AND VERTICAL LOCATION OF UTILITIES PRIOR TO CONSTRUCTION

ARIZONA 811
Call 811 or click Arizona811.com

REVISION	BY	DATE

CITY OF PRESCOTT
PRESCOTT REGIONAL AIRPORT
PRC PROJECT NO 2024-066-11 | DIBBLE PROJECT NO 1023143.11
SAFE - OFF-SITE DRAINAGE IMPROVEMENTS

STORM DRAIN
PLAN & PROFILE 2

DRN: DSO	DES: MJH	CK: DHD	DRAWING	SHEET
DATE: 04/2024	DATE: 04/2024	DATE: 04/2024	GD1.2	10 OF 14

SCALE: 1"=20'(H) 1"=2'(V)

J:\2023\1023143.11_PRC_SAFE_DRAINAGE_IMPROVEMENTS\CAO\1023143.11-602-X - STRM_PROF.DWG Apr. 11, 2024 3:13 PM

PRC SAFE - OFF-SITE DRAINAGE IMPROVEMENTS, 100% SUBMITTAL, 4/11/2024

NOTE:
 1. THE TOP OF THE 30-INCH RIP RAP SECTION SHALL BE APPROX. 6-INCHES ABOVE THE FINISHED GRADES ON THE INLET SIDE OF ALL FLARED END SECTIONS, ALL STORM DRAIN MANHOLES, AND CATCH BASIN INLETS. THE RIP RAP SHALL BE FLUSH WITH ADJACENT FINISHED GRADES ON THE OUTLET SIDE OF ALL FLARED END SECTIONS.

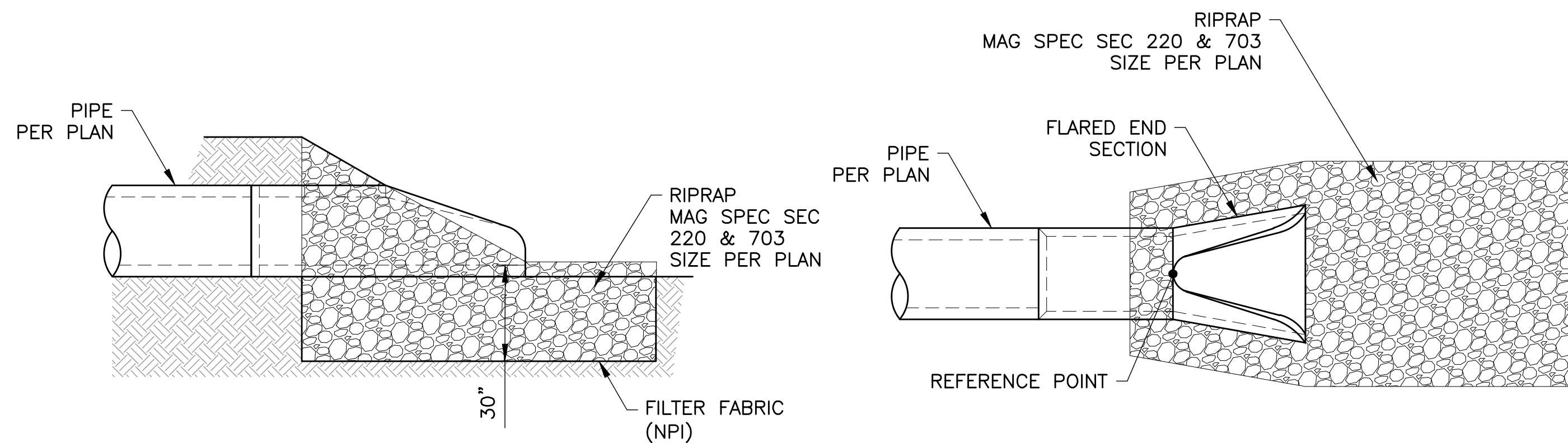

1 RIPRAP W/FILTER FABRIC NTS

PIPE DIA.	APPROX. WEIGHT (LBS.)	DIMENSIONS - INCHES						APPROX. SLOPE
		T	A	B	C	E	F	
24"	1520	3	9-1/2	43-1/2	30	73-1/2	48	3
27"	1930	3-1/4	10-1/2	49-1/2	24	73-1/2	54	3
30"	2190	3-1/2	12	54	19-3/4	73-3/4	60	3
36"	4100	4	15	63	34-3/4	97-3/4	72	3
42"	5380	4-1/2	21	63	35	98	78	3
48"	6550	5	24	72	26	98	84	3
54"	8240	5-1/2	27	65	33-1/4	98-1/4	90	2 1/2

NOTES

- DESIGN OF END SECTION SHALL CONFORM TO STANDARD FOR REINFORCED CONCRETE PIPE.
- END SECTION JOINT CONFORMATION SHALL MATCH THE PIPE JOINTS.
- EMBANKMENT SLOPE SHALL BE WARPED TO MATCH SLOPE OF END SECTION.
- CULVERT LENGTH IS AS SHOWN ON PLANS.

DETAIL NO. **545** MARICOPA ASSOCIATION OF GOVERNMENTS STANDARD DETAIL ENGLISH END SECTION-REINFORCED CONCRETE PIPE REVISED 01-01-1998 DETAIL NO. **545**

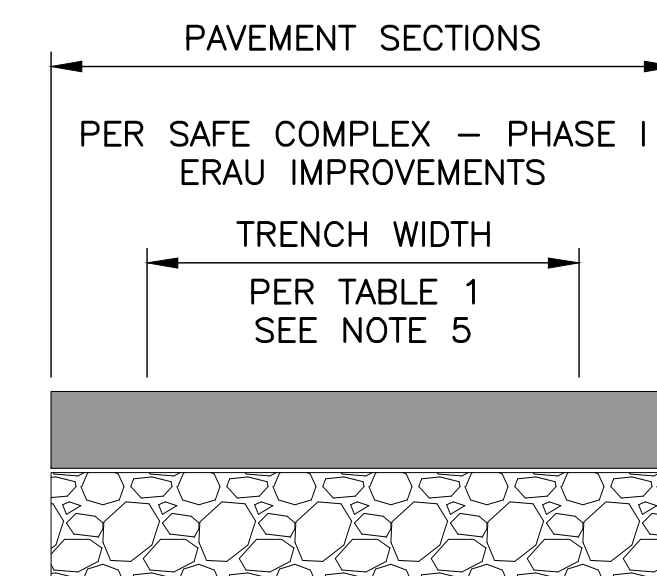

PIPE DIAMETER	TRENCH WIDTH
30"	7'-1/2"
36"	9'-2"
42"	9'-8"

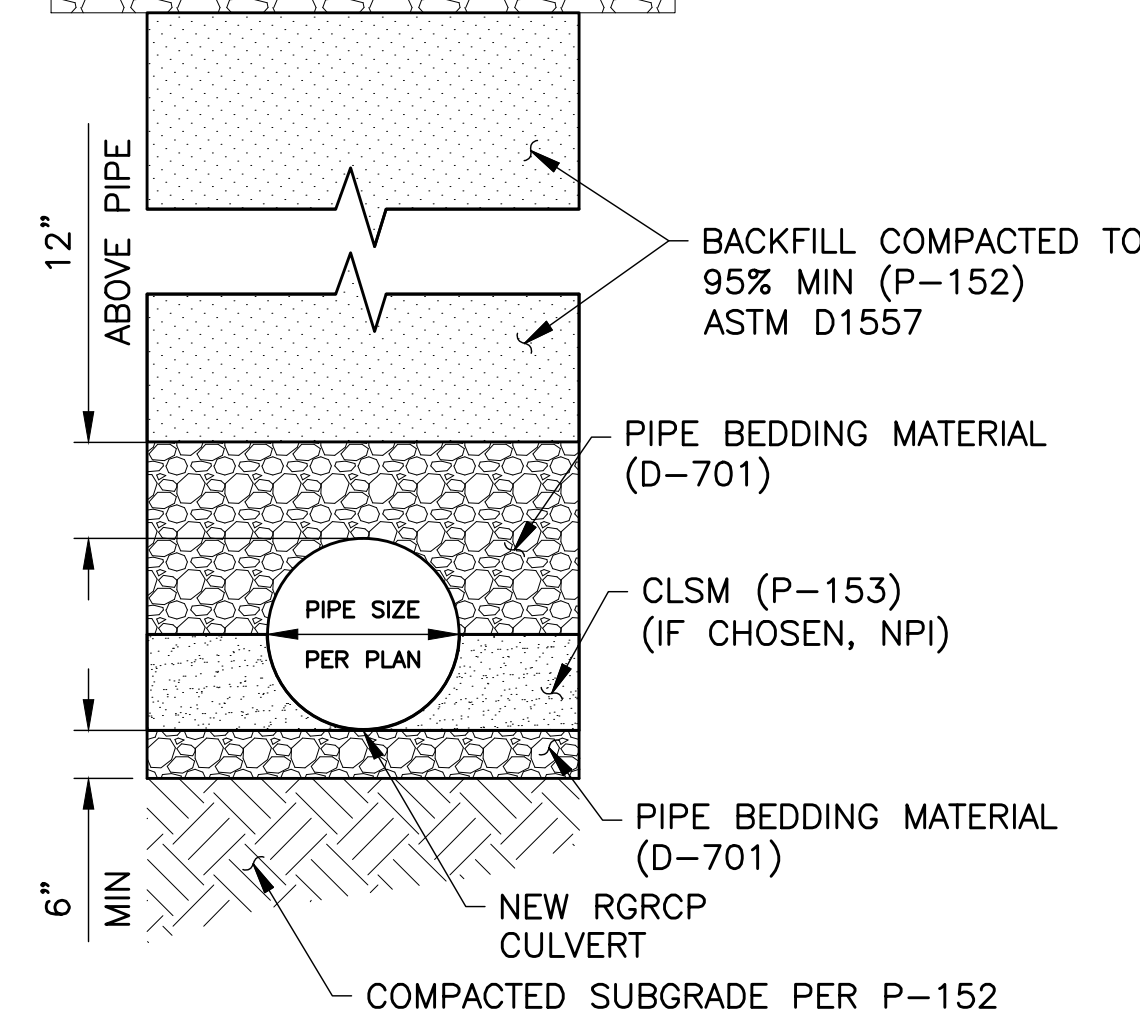

TRENCH WIDTH NOTES:

- CLSM MAY BE USED AT THE CONTRACTORS DISCRETION FROM SPRINGLINE TO TOP OF COMPACTED SUBGRADE AT NO ADDITIONAL COST TO OWNER.
- REFER TO DET 2 FOR PIPE SPACING AT CROSSINGS REQUIRING MULTIPLE PIPES.
- FOR STORM DRAIN PIPE WITHIN INFIELD EARTHEN BACKFILL TO BE CONSTRUCTED AND COMPACTED PER DET 3 TO FINISH GRADE SHOWN ON PLANS.
- APPROX TRENCH WIDTHS CALCULATED WITH THE CONSIDERATION OF FLARED END SECTIONS.

2 TRENCH WIDTH AND BACKFILL NTS

REVISION	BY	DATE

**CITY OF PRESCOTT
 PRESCOTT REGIONAL AIRPORT**

PRC PROJECT NO 2024-066-11 | DIBBLE PROJECT NO 1023143.11

SAFE - OFF-SITE DRAINAGE IMPROVEMENTS

STORM DRAIN DETAILS

DRN: DSO | DES: MJH | CK: DHD | DRAWING | SHEET
 DATE: 04/2024 | DATE: 04/2024 | DATE: 04/2024
 SCALE: NTS | GD2.1 | 11 OF 14



AS BUILT DATE



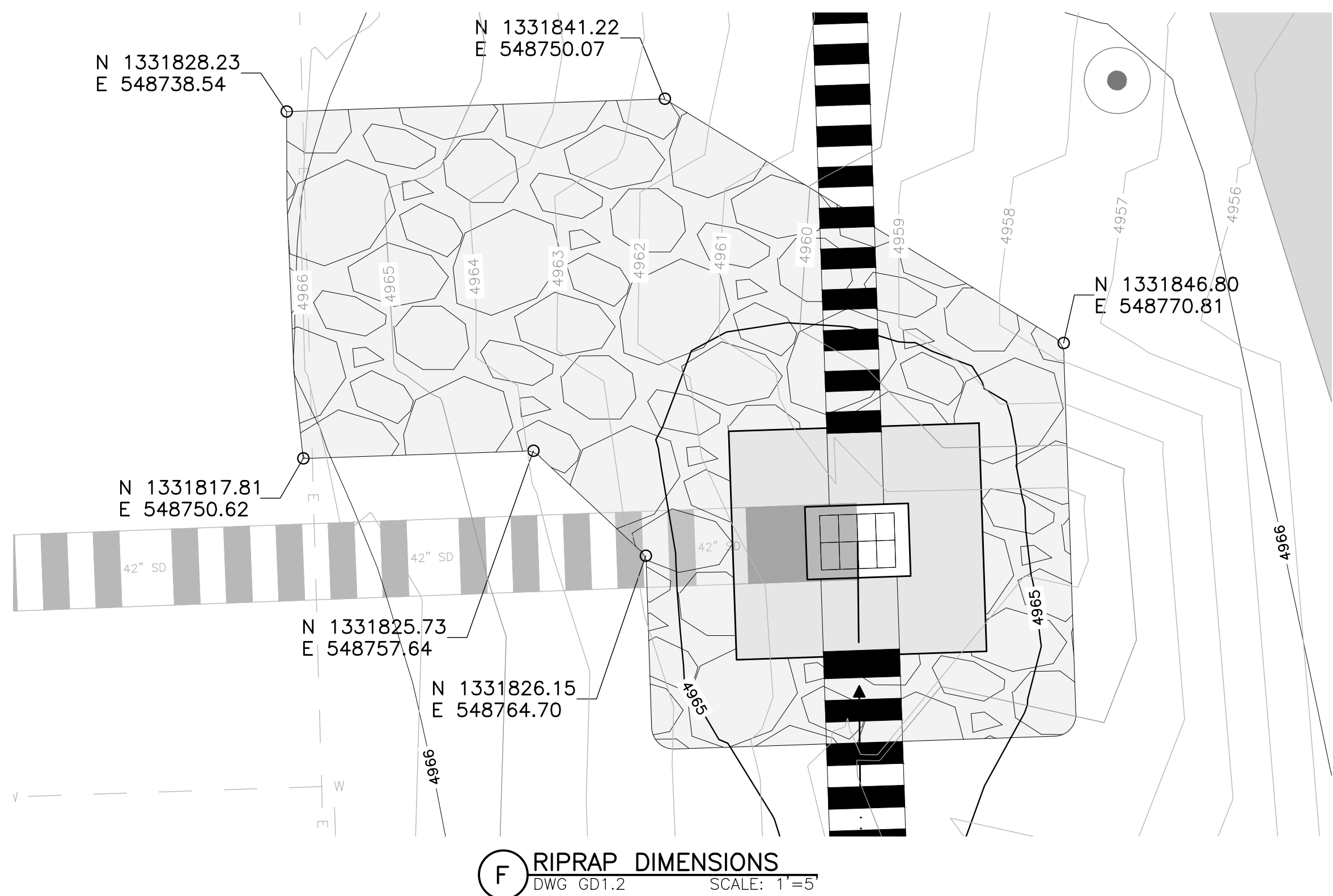
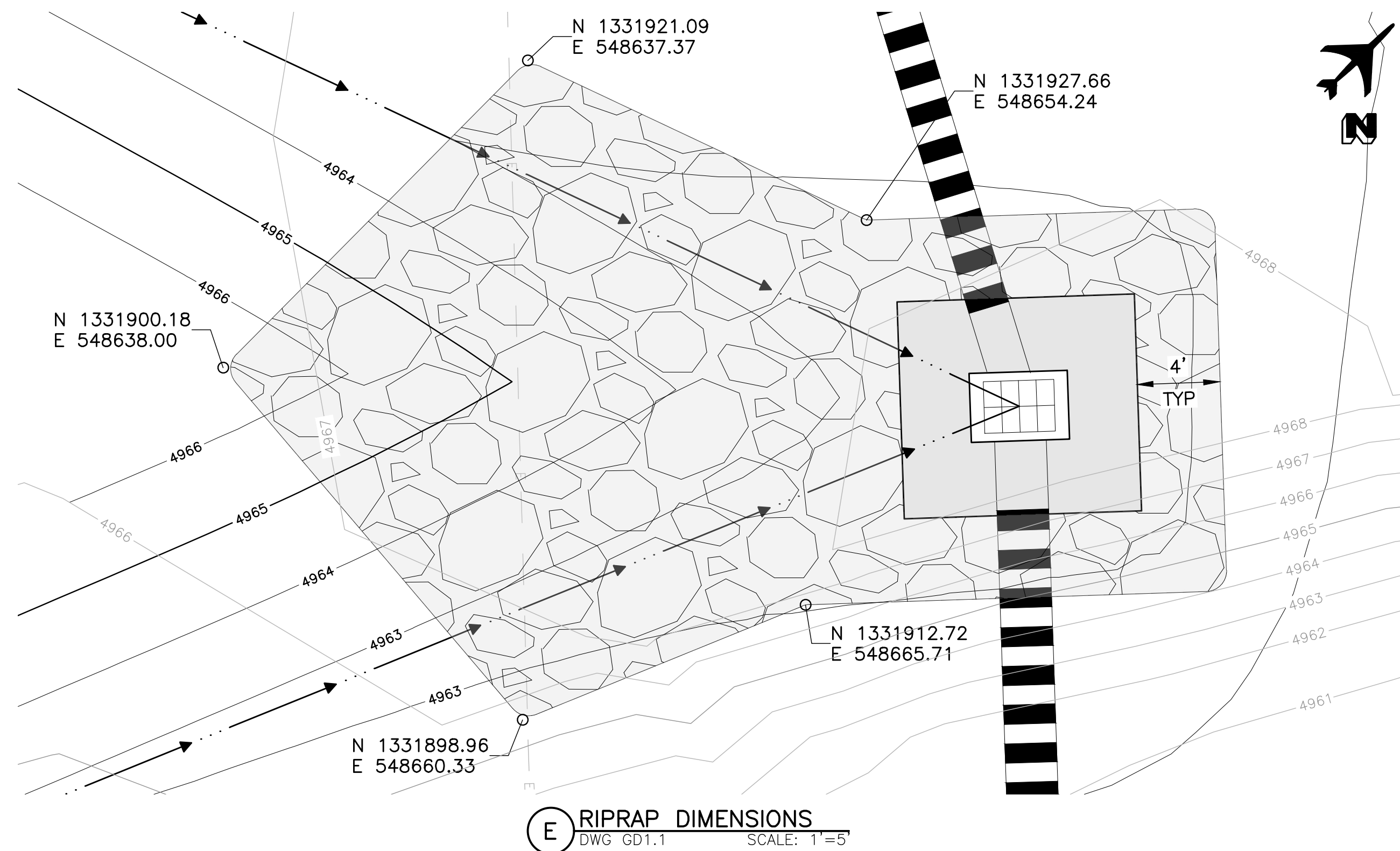
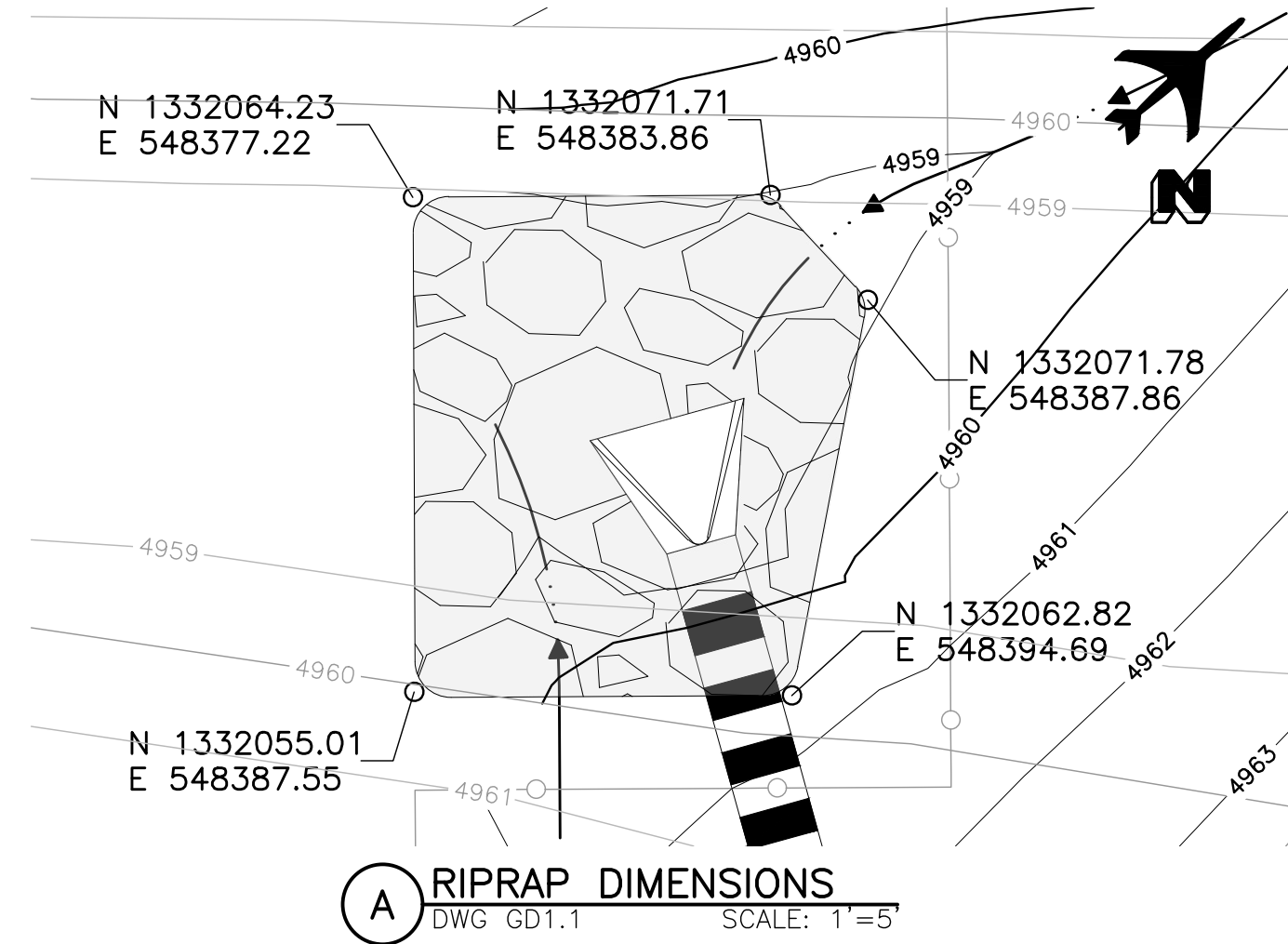

J:\2023\1023143.11_PRC_SAFE_DRAINAGE_IMPROVEMENTS\CAO\1023143.11-GD3_X - STRM-DETL.DWG Apr. 11, 2024 3:18 PM

PRC SAFE - OFF-SITE DRAINAGE IMPROVEMENTS, 100% SUBMITTAL, 4/11/2024

REVISION	BY	DATE

**CITY OF PRESCOTT
 PRESCOTT REGIONAL AIRPORT**

PRC PROJECT NO 2024-066-11 | DIBBLE PROJECT NO 1023143.11

SAFE - OFF-SITE DRAINAGE IMPROVEMENTS

RIPRAP DIMENSIONS



DRN: DSO	DES: MJH	CK: DHD	DRAWING	SHEET
DATE: 04/2024	DATE: 04/2024	DATE: 04/2024	GD2.2	12 OF 14
SCALE: NTS				

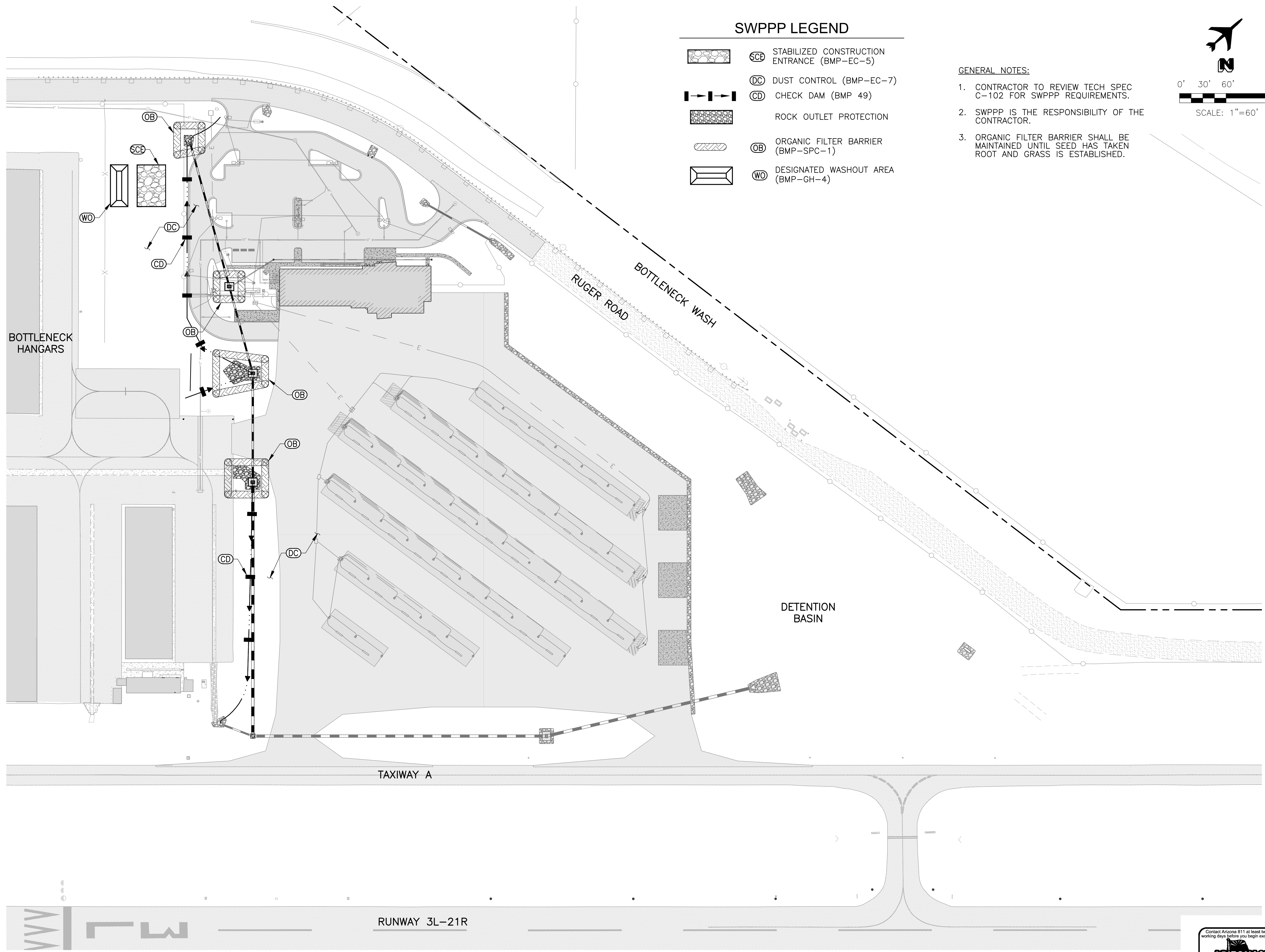

J:\2023\1023143.11_PRC_SAFE_DRAINAGE_IMPROVEMENTS\CAO\1023143.11-SW1_X - SWPPP.DWG Apr. 11, 2024 3:20 PM

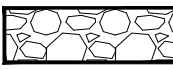

SWPPP LEGEND

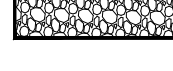
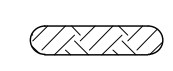
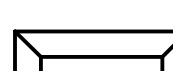
-  SCB STABILIZED CONSTRUCTION ENTRANCE (BMP-EC-5)
-  DC DUST CONTROL (BMP-EC-7)
-  CD CHECK DAM (BMP 49)
-  ROCK OUTLET PROTECTION
-  OB ORGANIC FILTER BARRIER (BMP-SPC-1)
-  WO DESIGNATED WASHOUT AREA (BMP-GH-4)

GENERAL NOTES:

1. CONTRACTOR TO REVIEW TECH SPEC C-102 FOR SWPPP REQUIREMENTS.
2. SWPPP IS THE RESPONSIBILITY OF THE CONTRACTOR.
3. ORGANIC FILTER BARRIER SHALL BE MAINTAINED UNTIL SEED HAS TAKEN ROOT AND GRASS IS ESTABLISHED.

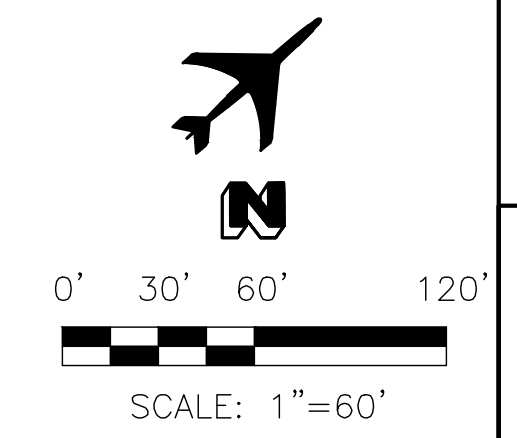

AS BUILT DATE

DIBBLE

REVISION	BY	DATE

**CITY OF PRESCOTT
PRESCOTT REGIONAL AIRPORT**

PRC PROJECT NO 2024-066-11 | DIBBLE PROJECT NO 1023143.11

SAFE - OFF-SITE DRAINAGE IMPROVEMENTS

SWPPP & EROSION CONTROL PLANS

DRN: DSO	DES: MJH	CK: DHD	DRAWING	SHEET
DATE: 04/2024	DATE: 04/2024	DATE: 04/2024	SW1.0	13 OF 14

SCALE: 1"=60'



PRC SAFE - OFF-SITE DRAINAGE IMPROVEMENTS, 100% SUBMITTAL, 4/11/2024

